

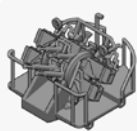
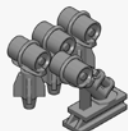

www.blackcatmodels.eu
contact@blackcatmodels.eu

A

B

C

D

E

F1

F2

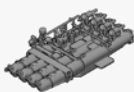
G1

G2

H1

H2

H3

H4

H5

H6

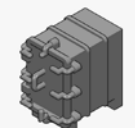
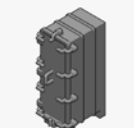
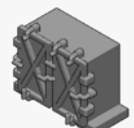
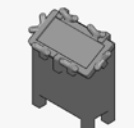
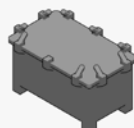
H7

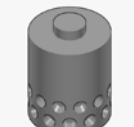
I1

I2

I3

I4

I5

J1

J2

K

L

M1

M2

N

BLACK CAT MODELS PART LIST

- A - 2 PDR. POM POM MK.VIII GUN ON QUAD MOUNT MK.VII (x1)
- B - MK.II DEPTH CHARGE THROWER AND DEPTH CHARGES (x2)
- C - DEPTH CHARGES RELEASE TRACK FOR MK.VII DEPTH CHARGES (x1)
- D - 16' DINGHY (x1)
- E - 25' FAST MOTOR BOAT (x1), 25' MOTOR CUTTER (x1)
- F - 27' WHALER (x1), MK.IX QUADRUPLE TORPEDO TUBES (x1)
- G - CARLEY FLOAT N°20 (x8)
- H - STEAM WINDLASS (x1), CABLE REEL (x4), SAILING WHEEL (x1), COMPASS (x1), PELORUS (x1), ADMIRALTY 20" SIGNALLING PROJECTOR (x2), 24" SEARCHLIGHT PROJECTOR MK.II (x1)
- I - 4.7" GUN READY USE LOCKER TYPE 1 (x13), 4.7" GUN READY USE LOCKER TYPE 2 (x5), 4" GUN READY USE LOCKER (x4), VICKERS 0.50" MG AMMUNITION BOX (x4), 2PDR READY USE LOCKER (x2)
- J - PROPELLERS (x2), SMOKE POTS (x6)
- K - RANGEFINDER DIRECTOR MK.I OF 1937 (x1)
- L - GUNNERY CONTROL TOWER (x1)
- M - VICKERS 0.50" MG ON MARK I QUAD MOUNT / WITH SHIELD (x2 EACH)
- N - TWIN 4.7"/45 MK.XII GUN ON MK.XIX MOUNTING (x4)

2 PDR. POM POM MK.VIII GUN ON QUAD

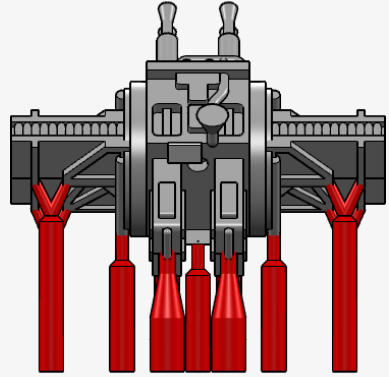
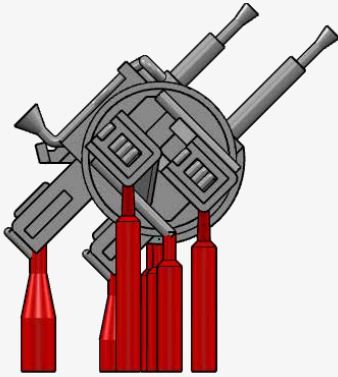
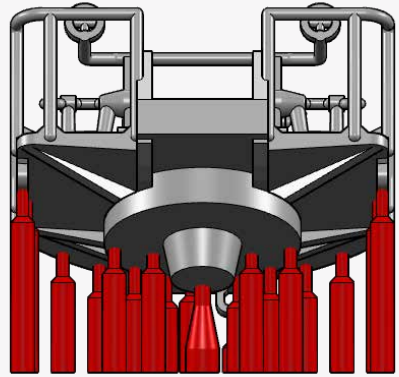
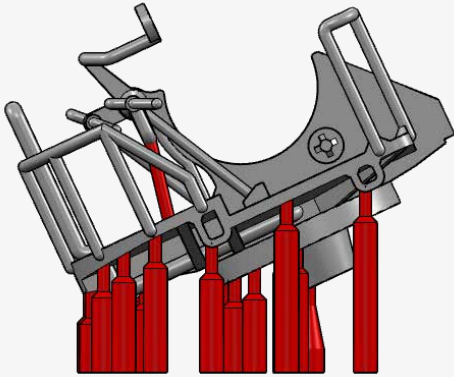

MK.II DEPTH CHARGE THROWER

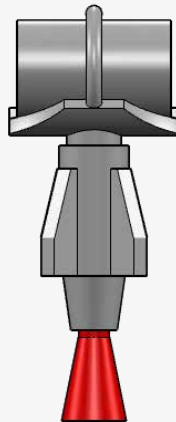
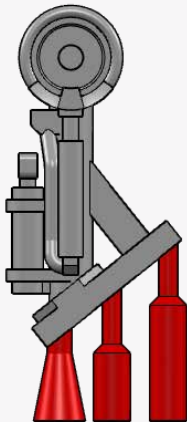

DEPTH CHARGES RELEASE TRACK

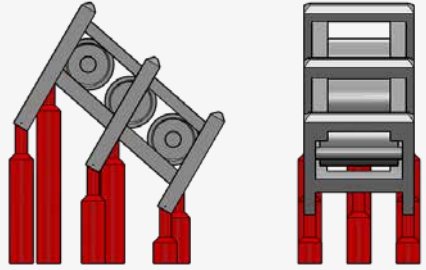
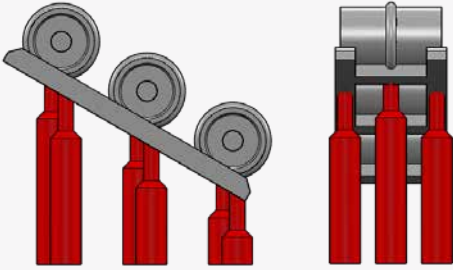

N°20 CARLEY FLOAT, 16' DINGHY

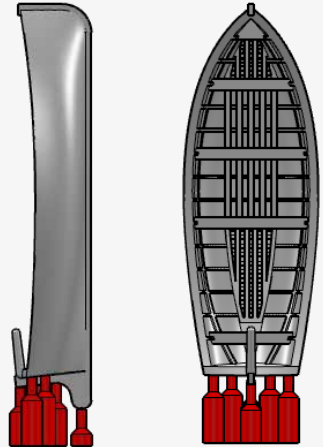
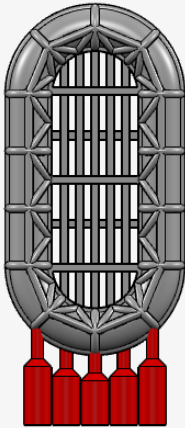

25' FAST MOTOR BOAT, 25' MOTOR CUTTER

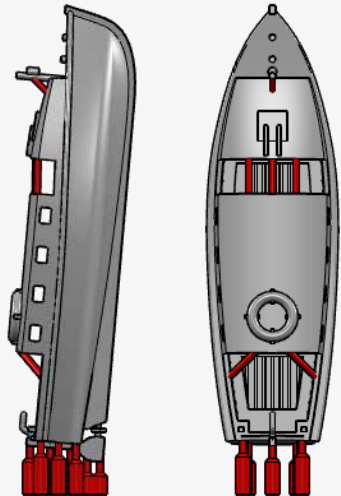
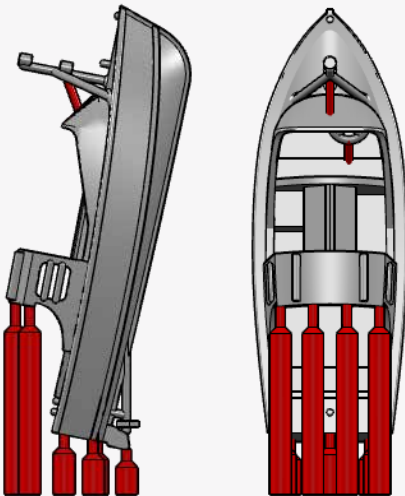

27' WHALER, MK.IX QUADRUPLE TORPEDO

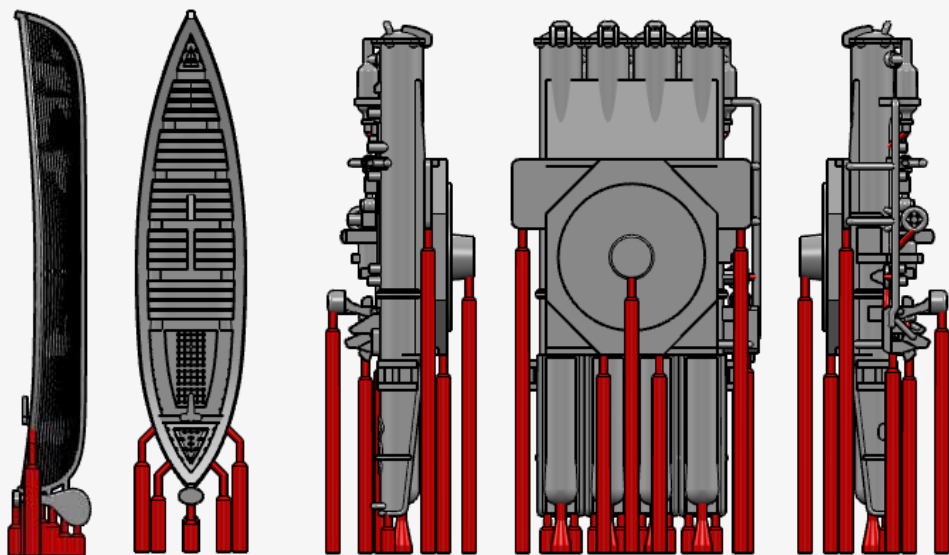

EQUIPMENT BAR

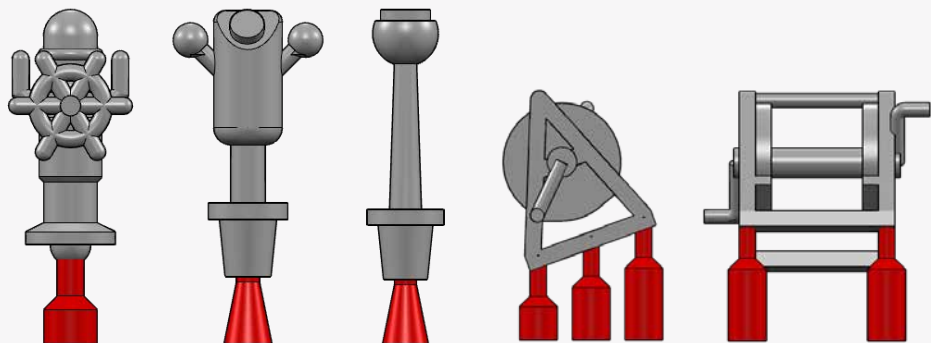
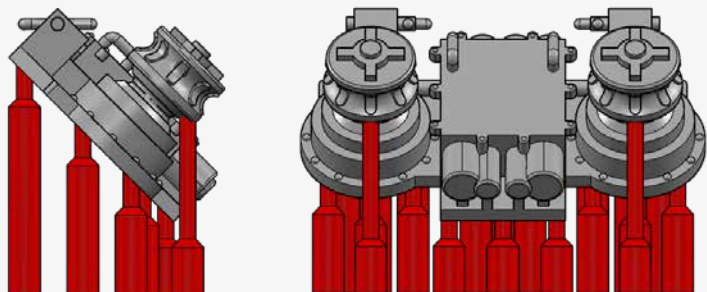

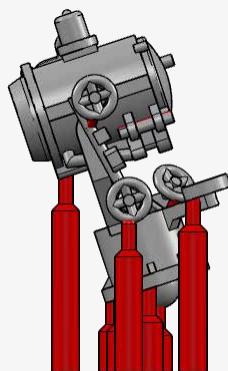
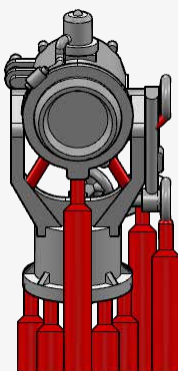
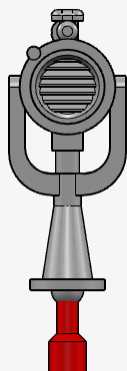

READY USE LOCKERS BAR

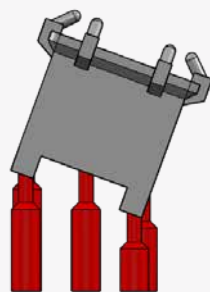
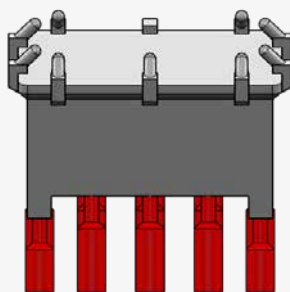
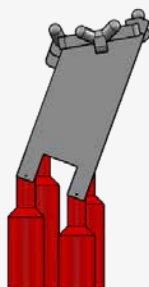
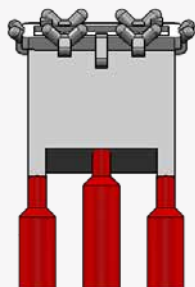
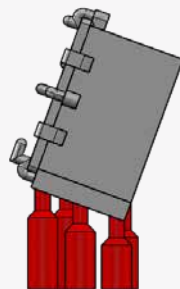
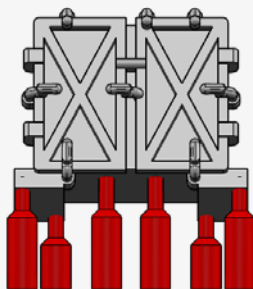
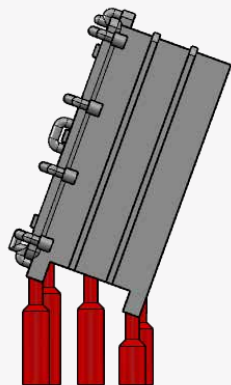
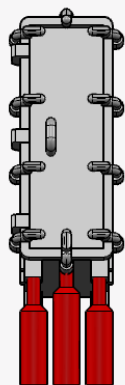
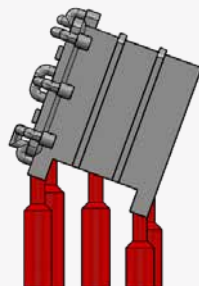
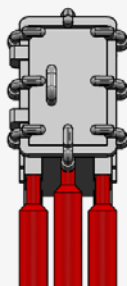

PROPELLERS, SMOKE POTS

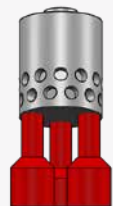
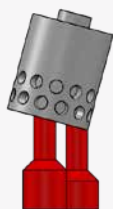
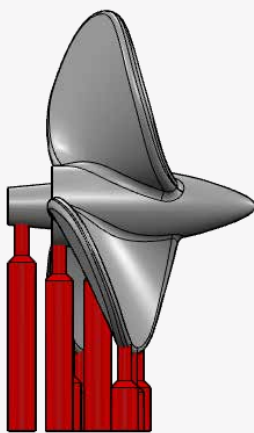
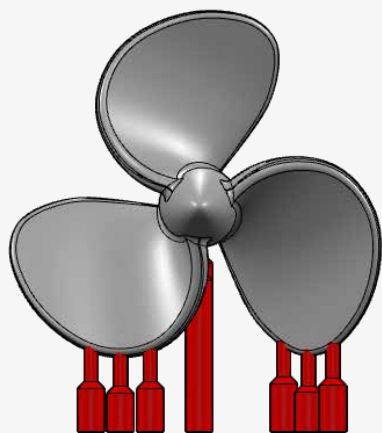

RANGEFINDER DIRECTOR MK.I

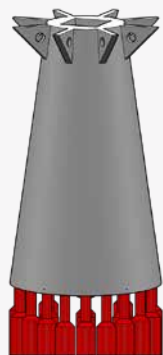
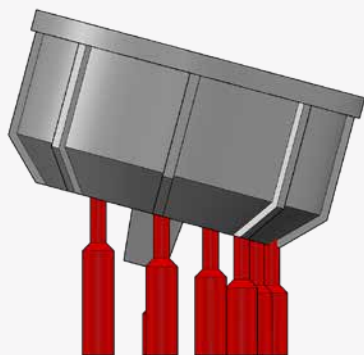
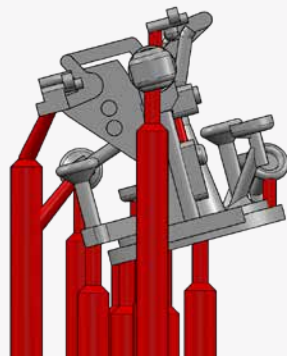
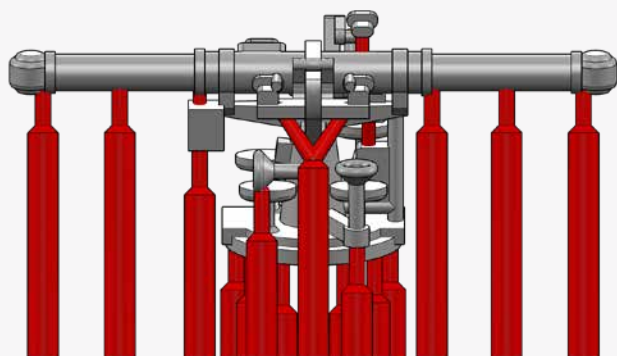

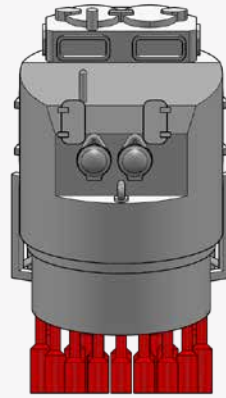
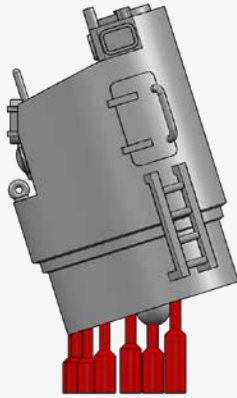

VICKERS 0.50" MG ON MARK I QUAD MOUNT

