



LCS(L) LANDING CRAFT SUPPORT

The landings at Tarawa exposed a vital need by the US Navy for vessels to provide close in support to landing troops. Experience showed that the interval between the end of shelling from the large ships and the arrival of the landing craft on the beach allowed the defenders to regroup. The Landing Craft Support (Large) Mark 3, or LCS(L) (3), was developed to fulfill this need. The hull was identical to those of Landing Craft Infantry (Large), LCI(L), which measured 158 ft 6 in (48.31 m) long, 23 ft 3 in (7.09 m) wide, drew 5 ft 10 in (1.78 m) and displaced 250 tons when fully loaded. A total of 130 ships were commissioned.

LCS(L)(3)s were heavily armed for ships of their size. The bow gun was typically a 3"/50 caliber gun, though a single or twin 40mm Bofors were fitted on some. A pair of twin 40mm Bofors and four 20mm Oerlikons were also mounted. Ten Mark 7 rocket launchers were placed behind the bow gun.

The first LCS(L)(3) ships arrived in time to support the landings at Iwo Jima and saw action throughout the remainder of the war. They were also used as radar picket stations, anti-aircraft platforms and to generate smoke screens. Five ships were sunk and 21 damaged during the war. After the war they were reclassified as Landing Ship Support, Large (LSSL). Some US ships were reactivated for the Korean War, while others were transferred to Japan, France, South Vietnam, Thailand, Greece and various other nations. One LCS(L)(3) serving with Thai Navy, HTMS Nakha ex-USS LCS(L)-102, was returned to the United States in 2007 to become a museum ship at the former Mare Island Naval Shipyard under the care of the National Association of USS LCS(L) 1-130.

XX	RESIN PARTS
XX	3D PARTS
XX	PHOTOETCH PARTS
XX	BRASS PARTS
XX	DECALS PARTS

!	ASSEMBLY WARNING
PS	PORT & STARBOARD
P	PORT SIDE
S	STARBOARD SIDE
X	INFORMATIONS

SOME PHOTOETCH AND 3D PARTS ARE PROVIDED IN EXTRA NUMBERS.

IMPORTANT ! PLEASE FULLY READ THE INSTRUCTIONS BEFORE STARTING THE BUILD !

PHOTOETCH

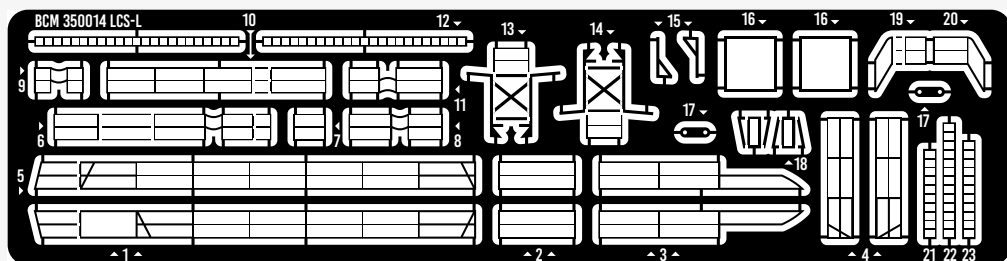

DECALS

0	0	0	0	0	0	0
1	1	1	1	1	1	1
2	2	2	2	2	2	2
3	3	3	3	3	3	3
4	4	4	4	4	4	4
5	5	5	5	5	5	5
6	6	6	6	6	6	6
7	7	7	7	7	7	7
8	8	8	8	8	8	8
9	9	9	9	9	9	9

BRASS

A	Ø : 0.3MM	L : 6MM	x1
B	Ø : 0.3MM	L : 8MM	x1
C	Ø : 0.3MM	L : 10MM	x1
D	Ø : 0.3MM	L : 12MM	x2
E	Ø : 0.5MM	L : 25MM	x1

PARTS

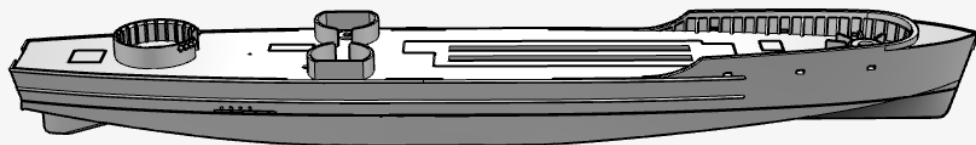

1

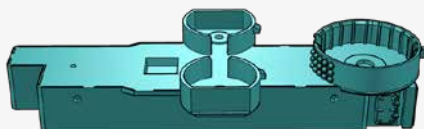

2

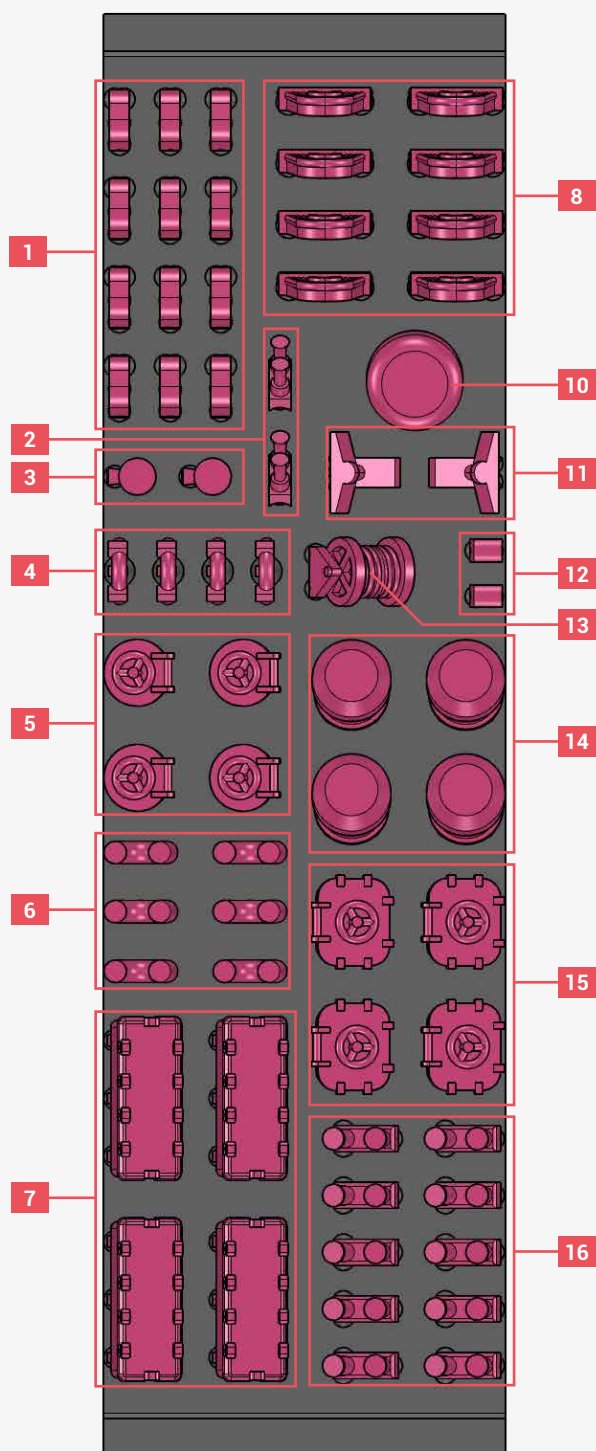

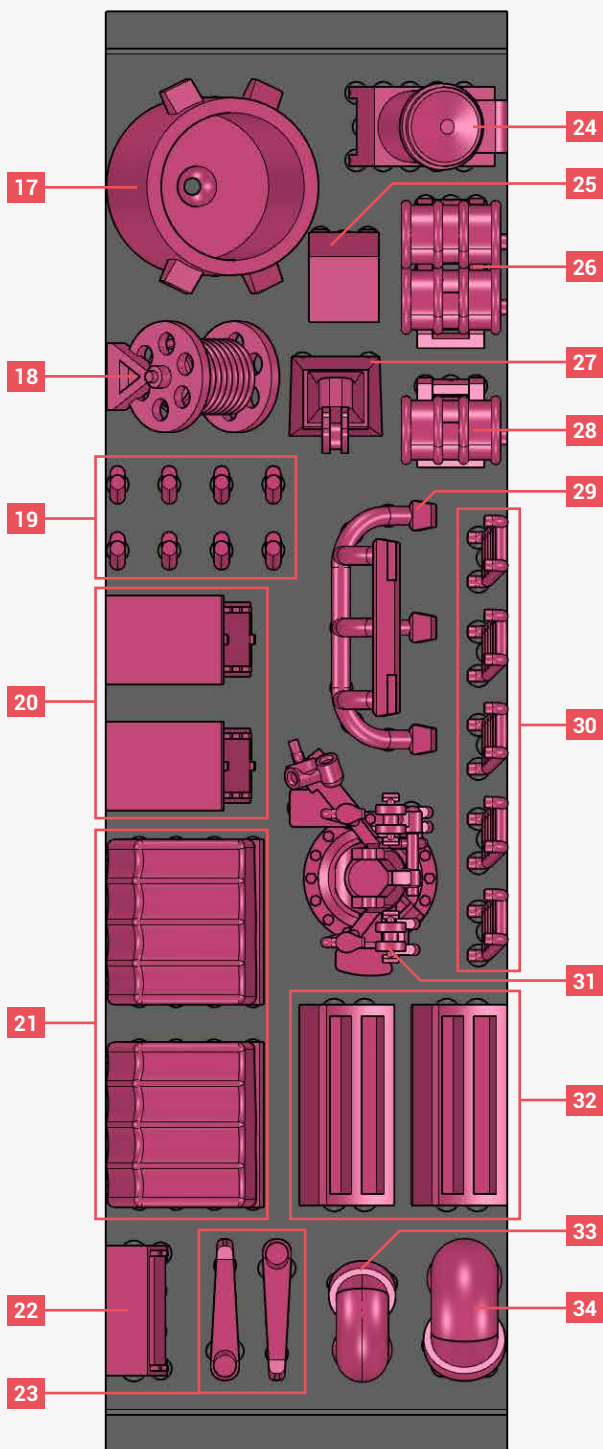

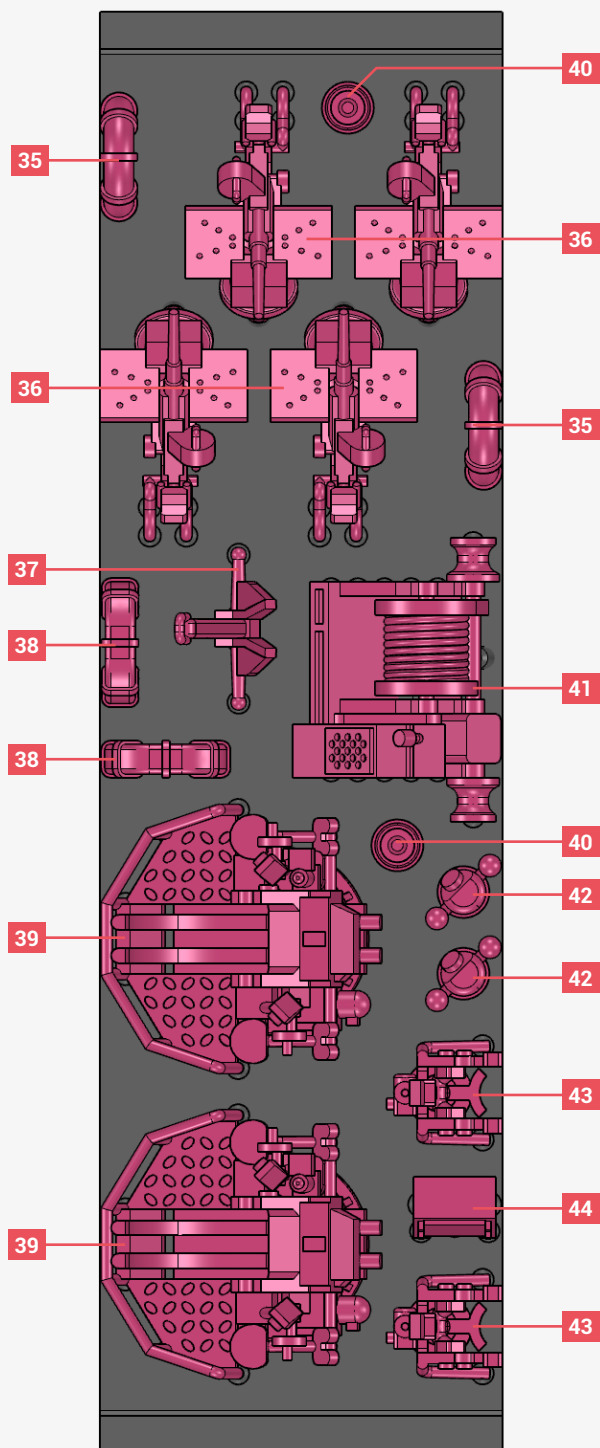

BAR D

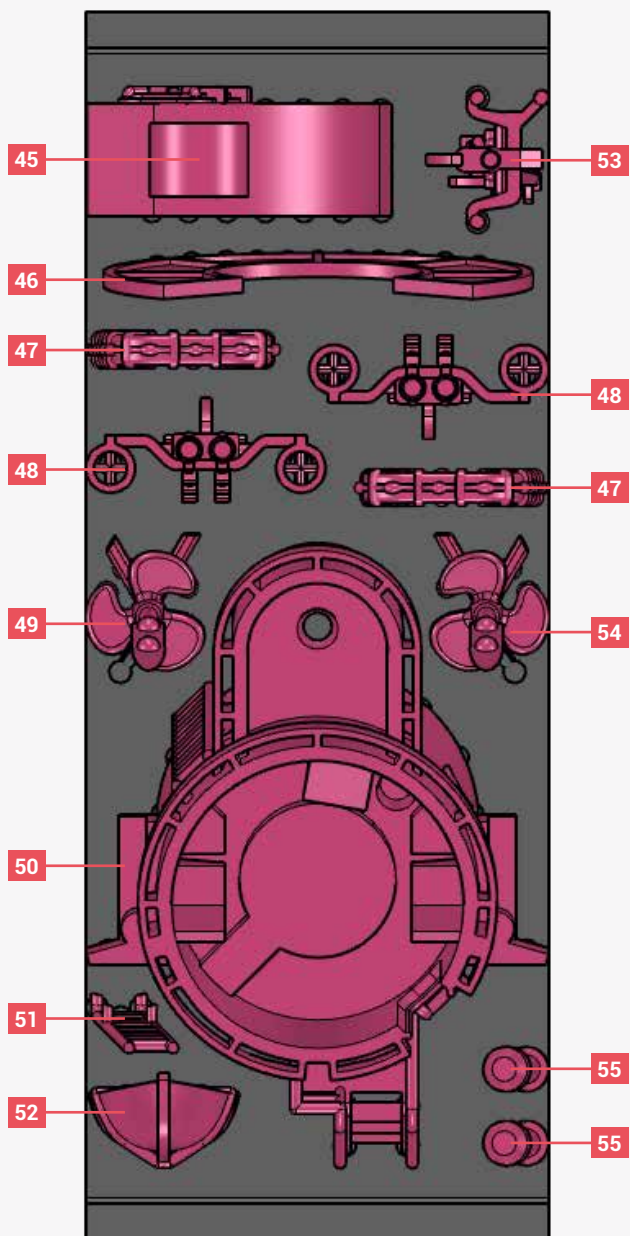

BAR E

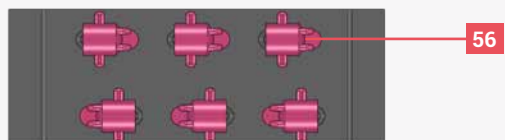

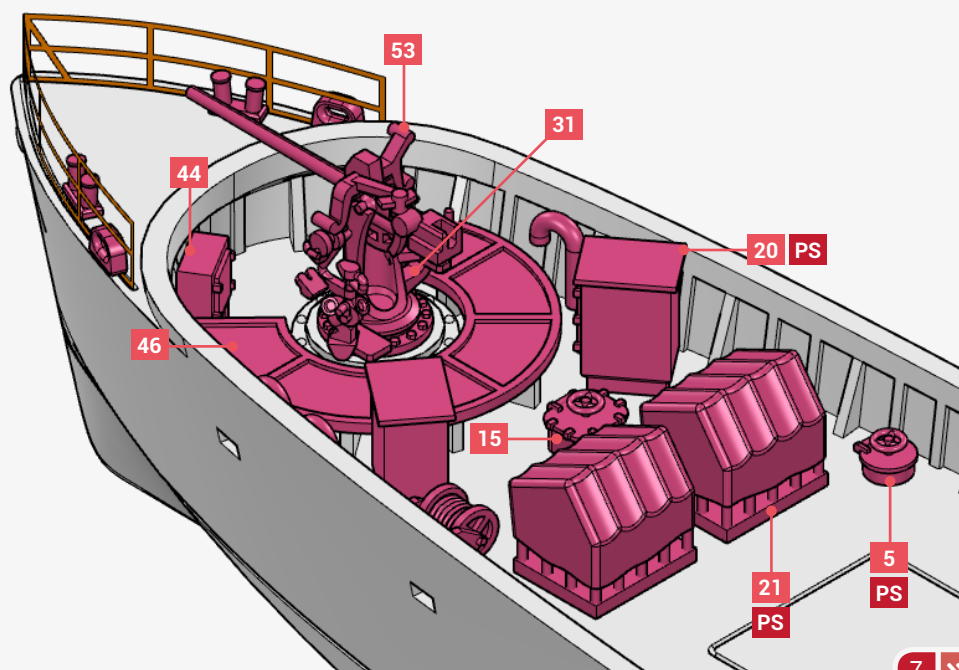
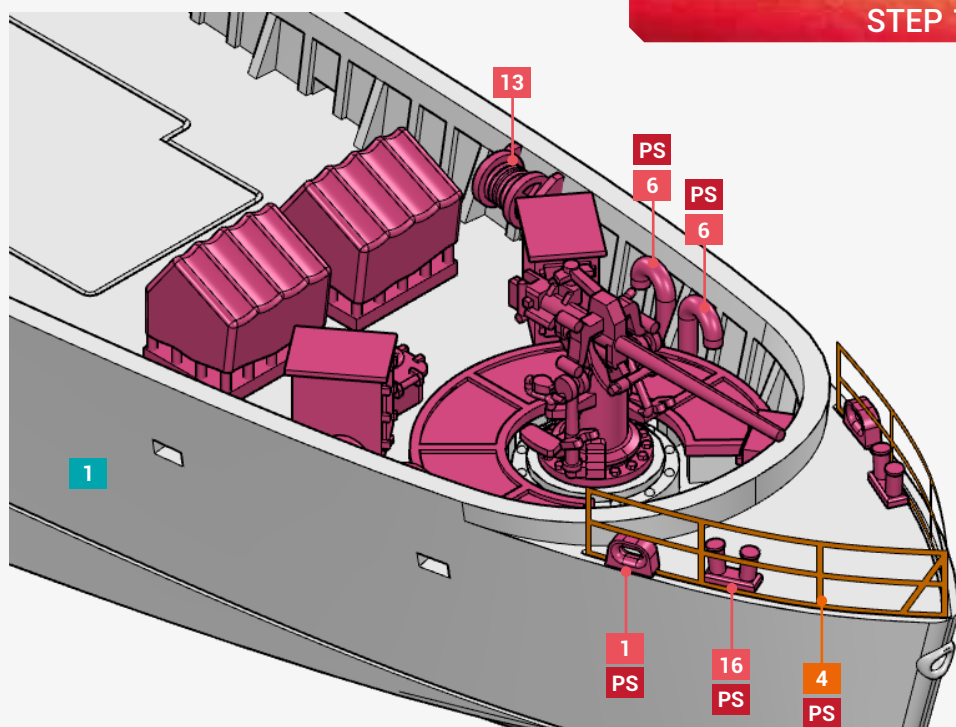

STEP 2

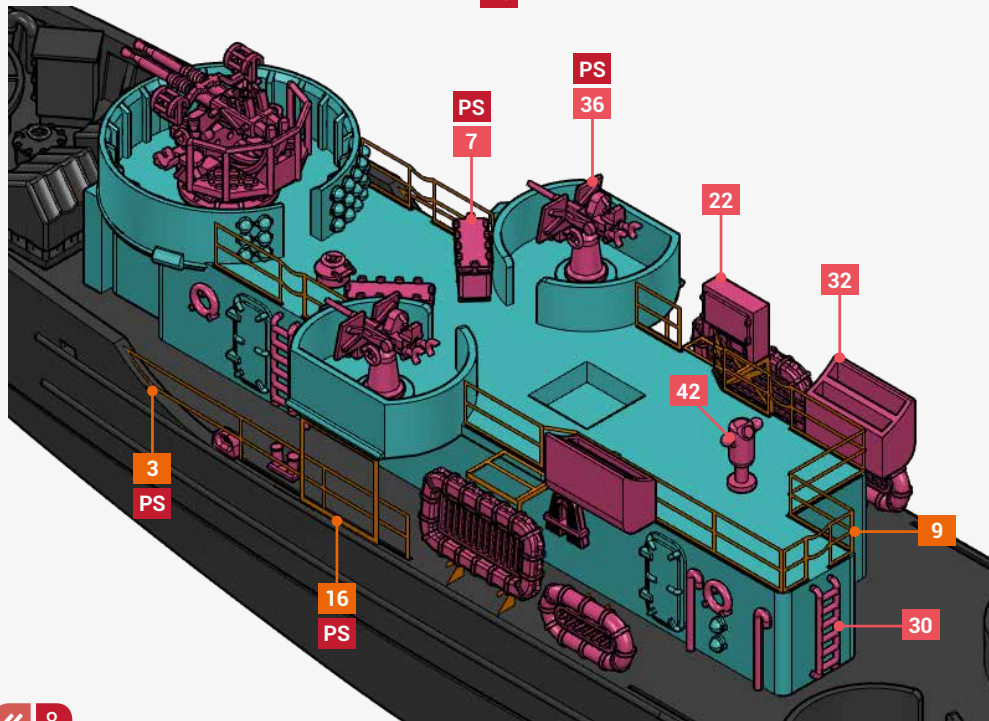
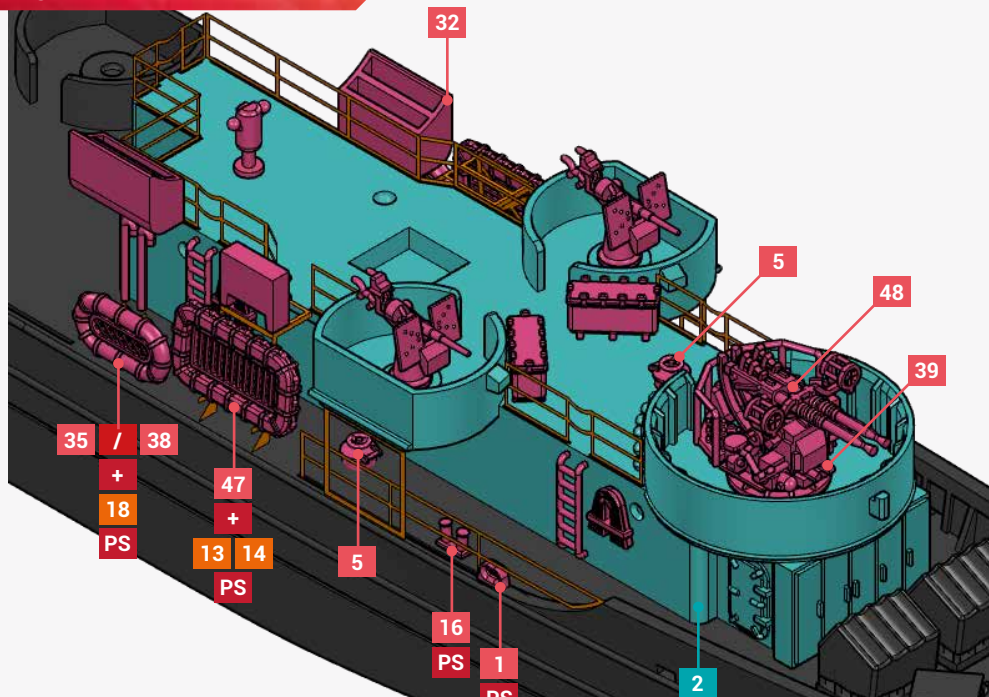

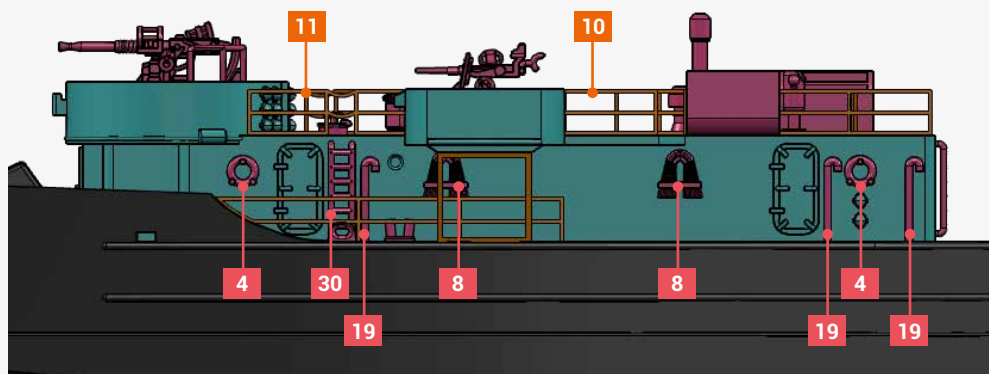
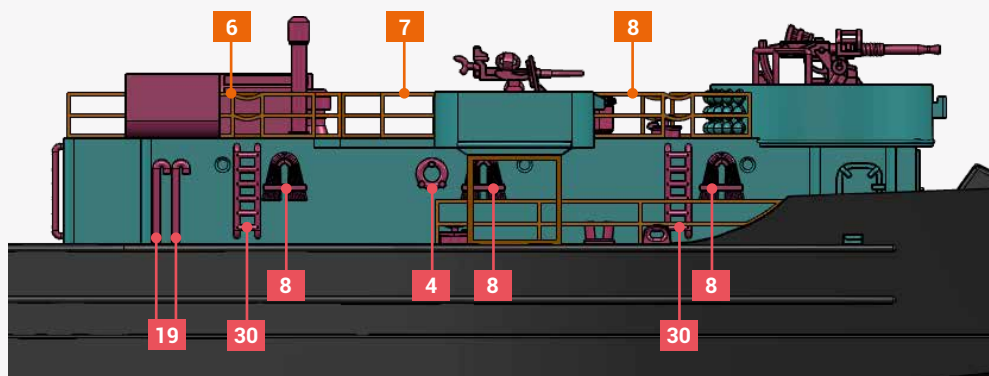

SOME SHIPS HAD SMALLER OVAL RAFTS (PART 35) FITTED AFT AND OTHERS SMALLER RECTANGULAR RAFTS (PART 38). PLEASE REFER TO PHOTOS ON NAVSOURCE.ORG FOR THE SHIP YOU WISH TO BUILD.

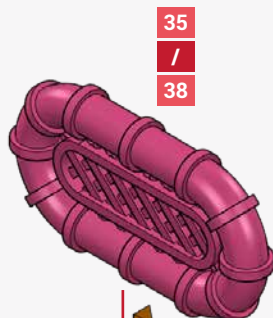
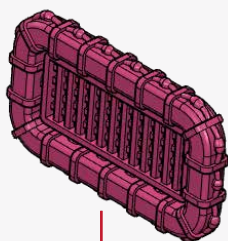

STEP 3

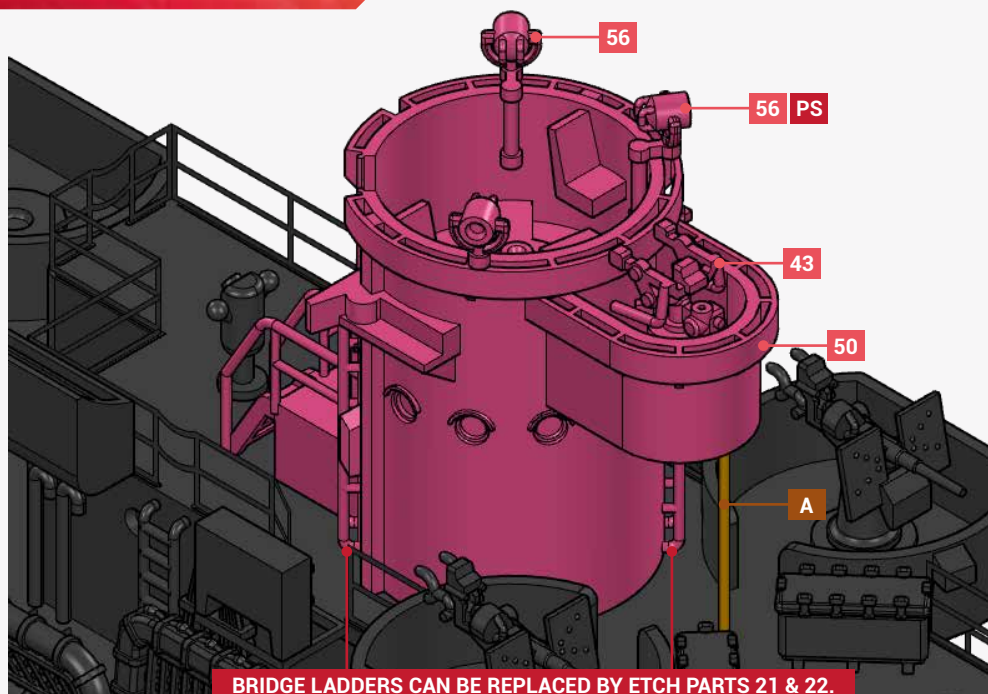

BRIDGE LADDERS CAN BE REPLACED BY ETCH PARTS 21 & 22.
BRIDGE RAILINGS CAN BE REPLACED BY ETCH PARTS 19 & 20.

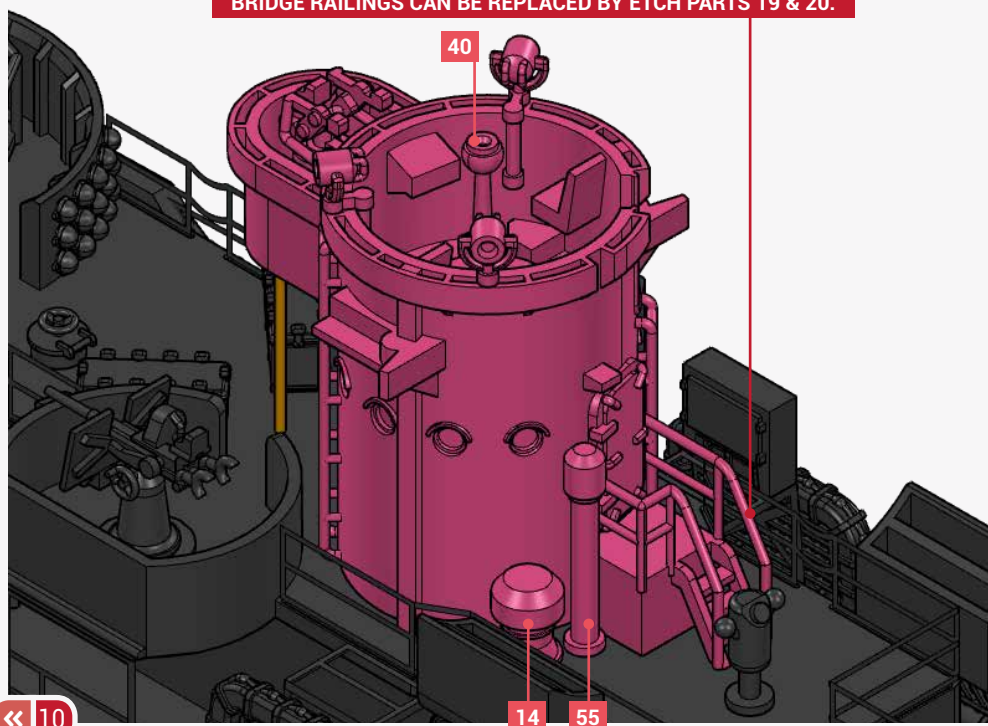

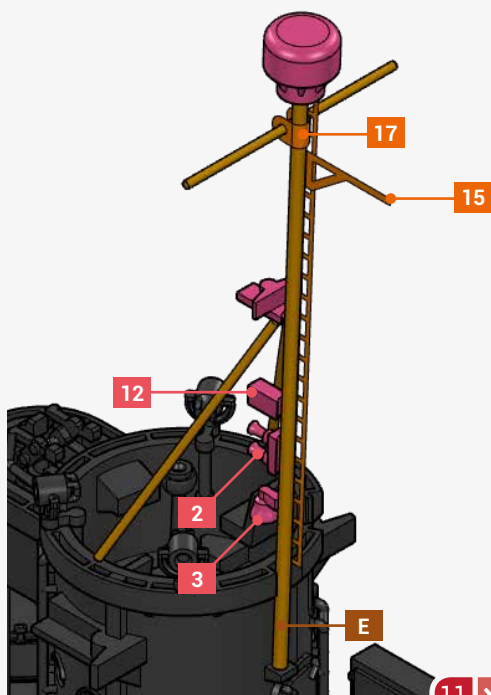
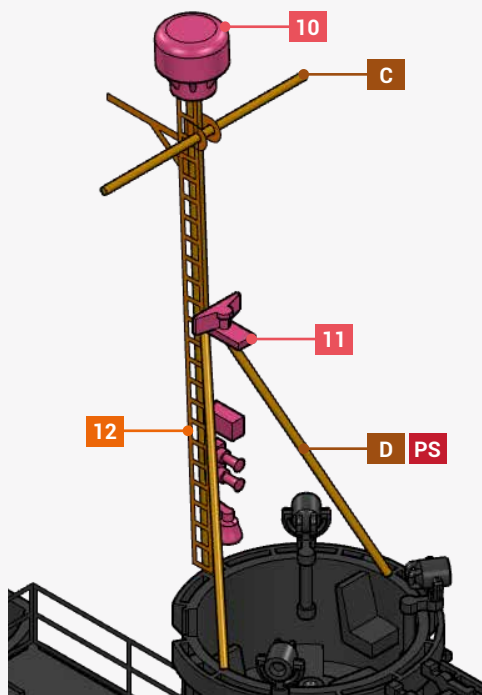
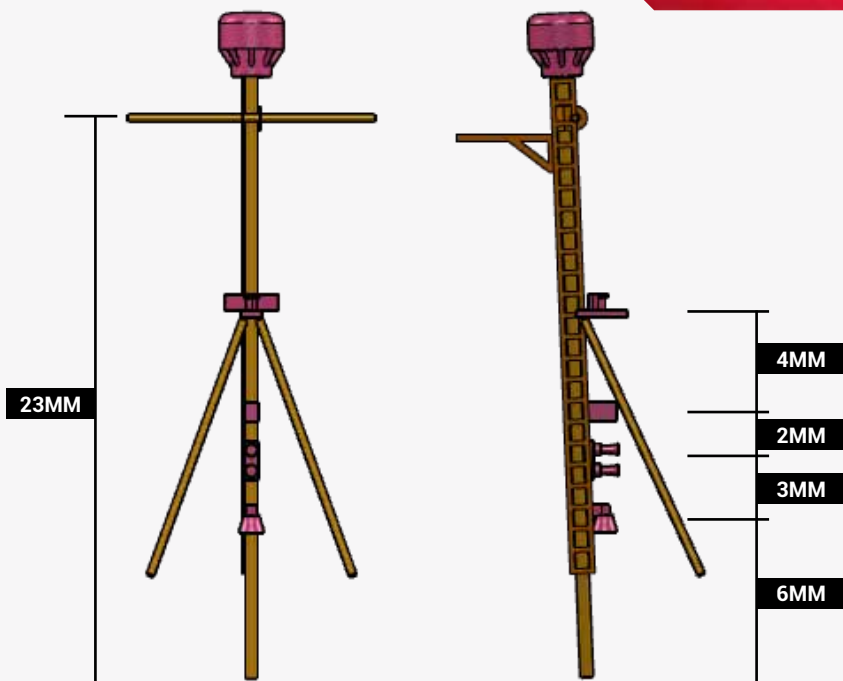

STEP 5

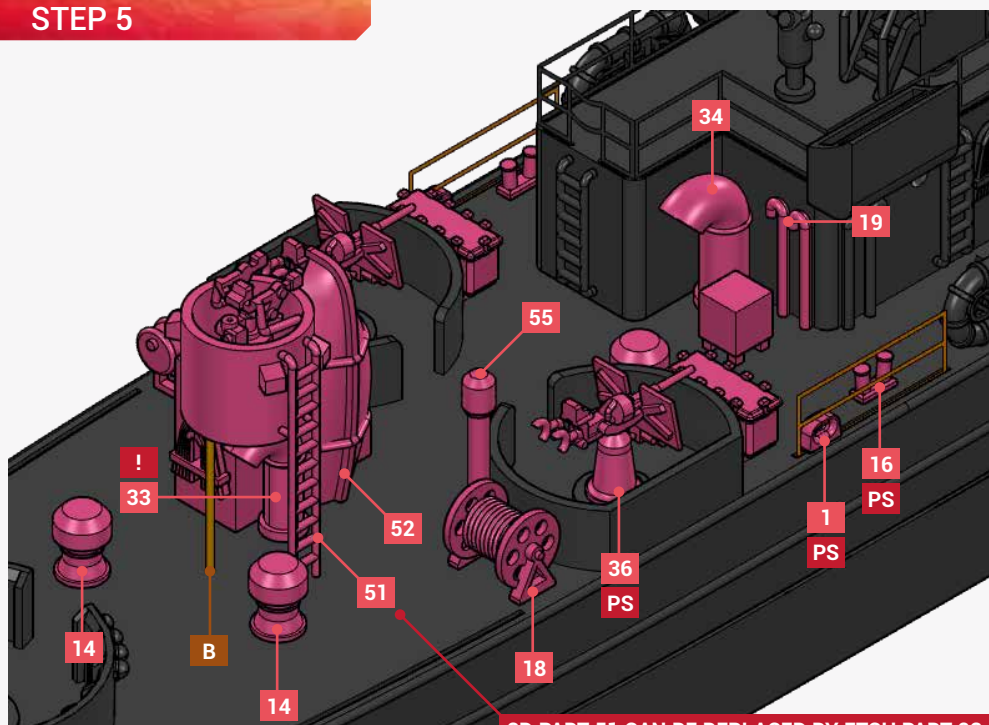

3D PART 51 CAN BE REPLACED BY ETCH PART 23.

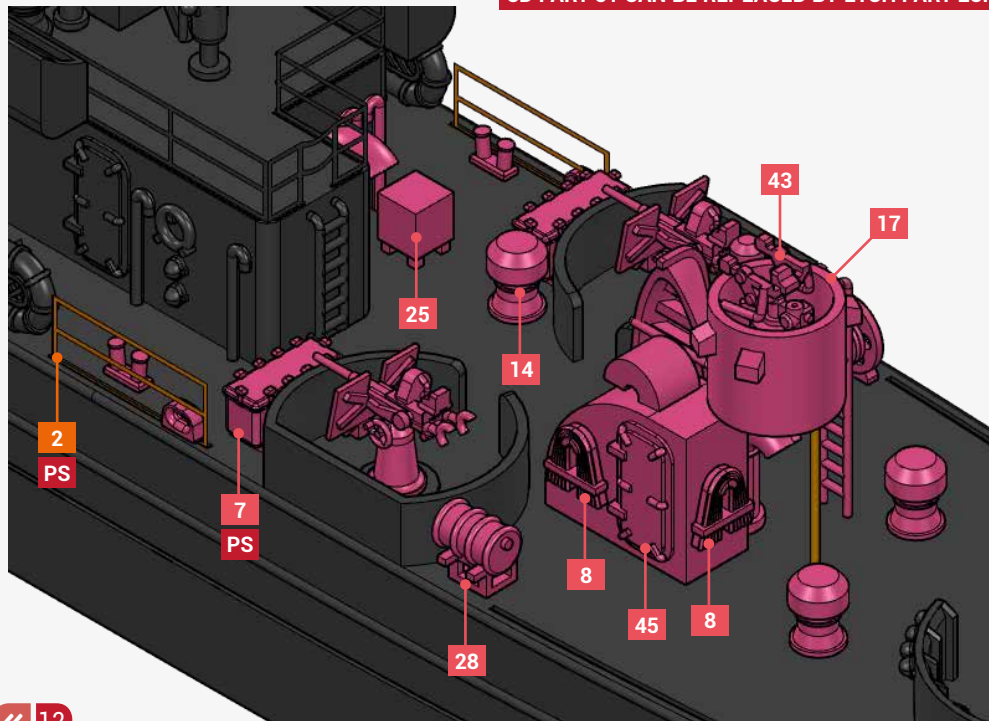

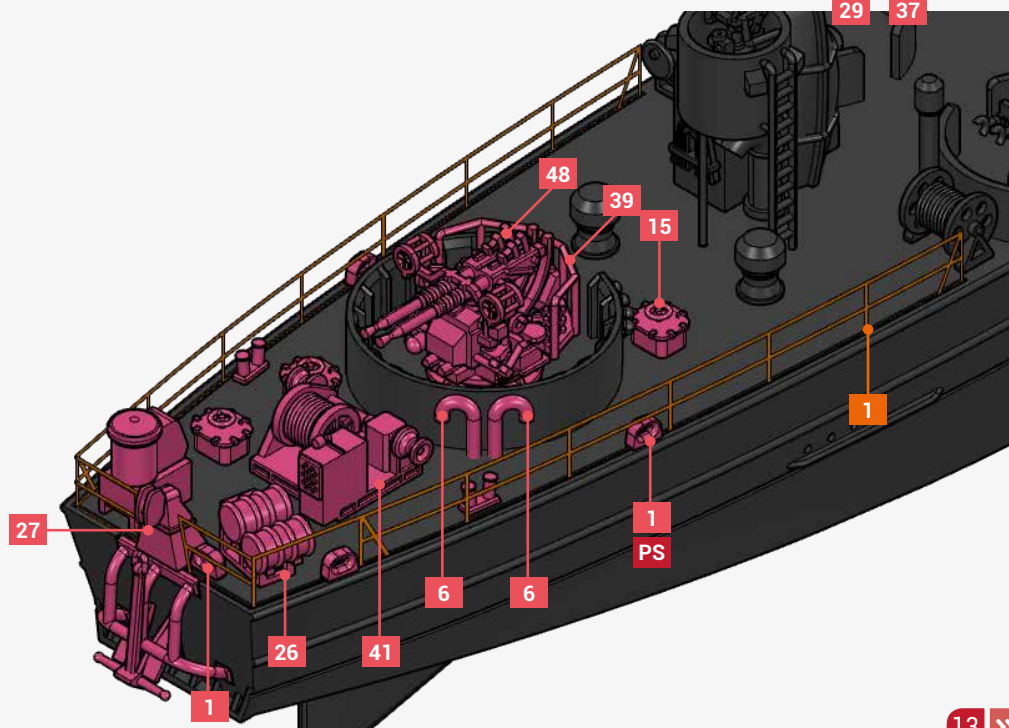
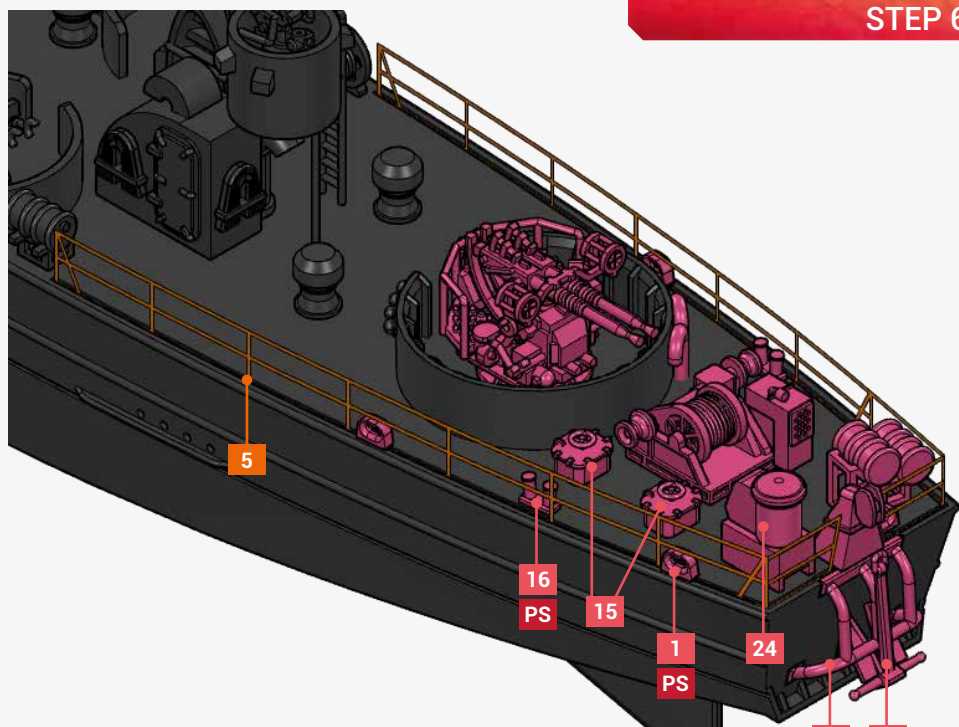

STEP 7

