



CAPTAIN CLASS FRIGATES

The concept of a mass produced escort vessel was introduced in mid 1939 by the United States Navy. Several designs were developed, but all were eventually rejected. However, a subsequent request by the British government for additional ocean escorts led to the development of what became known as the "destroyer escort".

A Gibbs & Cox design, following British Admiralty specifications, resulted in the Evarts class. The Gibbs & Cox design borrowed much from the Royal Navy Hunt class of escorts.

The Evarts class measured 289 feet 5 inches long and were known as the "short hull" destroyer escort. Later classes all measured 306 feet long and were called "long hull" destroyer escorts. A total of 97 Evarts class ships were built, with 32 going to the Royal Navy under the Lend-Lease Program. These ships were known as Captain class frigates.

After delivery, the ships were modified in order to match Admiralty requirements. The Captain class frigates were utilized as convoy escorts, anti-submarine warfare vessels, coastal forces control frigates and headquarters ships for the Normandy landings. The Royal Navy lost six Evarts type Captain class frigates during the war. After the war, all of the surviving Evarts type ships were returned to the USN.

XX	RESIN PARTS
XX	3D PARTS
XX	PHOTOETCH PARTS
XX	BRASS PARTS
XX	DECALS PARTS

!	ASSEMBLY WARNING
PS	PORT & STARBOARD
P	PORT SIDE
S	STARBOARD SIDE
X	INFORMATIONS

SOME PHOTOETCH AND 3D PARTS ARE PROVIDED IN EXTRA NUMBERS.

IMPORTANT ! PLEASE FULLY READ THE INSTRUCTIONS BEFORE STARTING THE BUILD !

PHOTOETCH

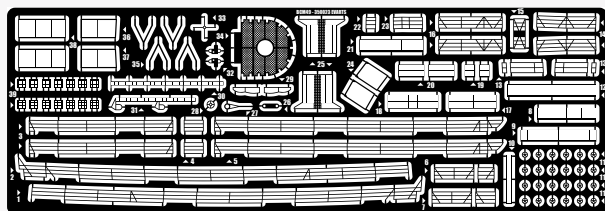

ADDITIONAL PHOTO ETCH PARTS



DECALS

9 9 9 9 9 9
8 8 8 8 8 8
7 7 7 7 7 7
6 6 6 6 6 6
5 5 5 5 5 5
4 4 4 4 4 4
3 3 3 3 3 3
2 2 2 2 2 2
1 1 1 1 1 1
K K K K K K
K K K K K K
K K K K K K
K K K K K K
K K K K K K

BRASS



C	x1	Ø=0.3MM L=8MM
D	x1	Ø=0.4MM L=18MM

PARTS

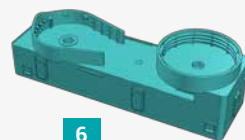
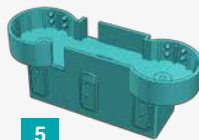
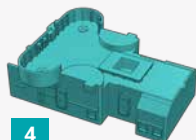
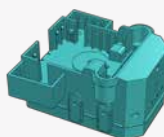
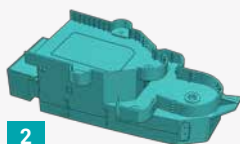
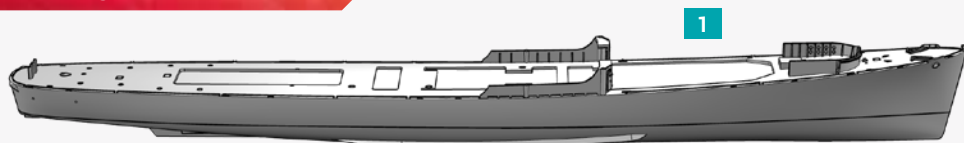

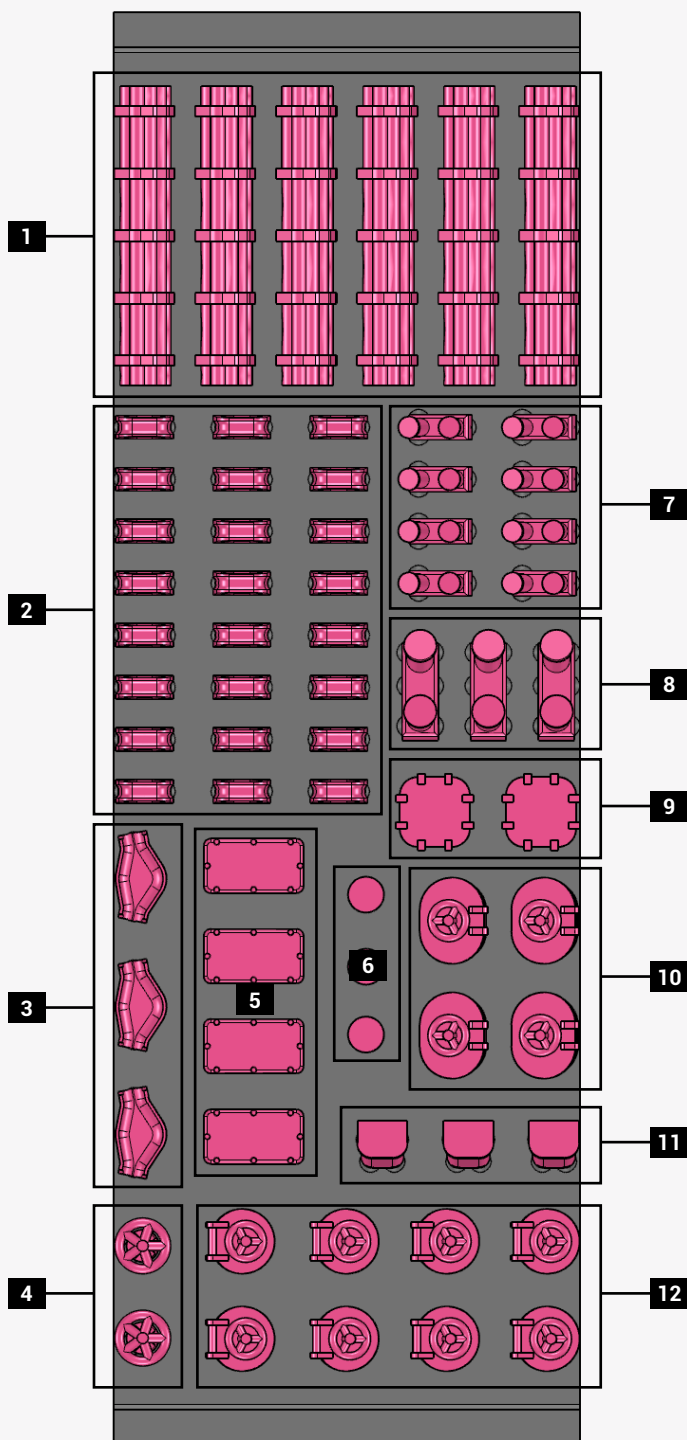

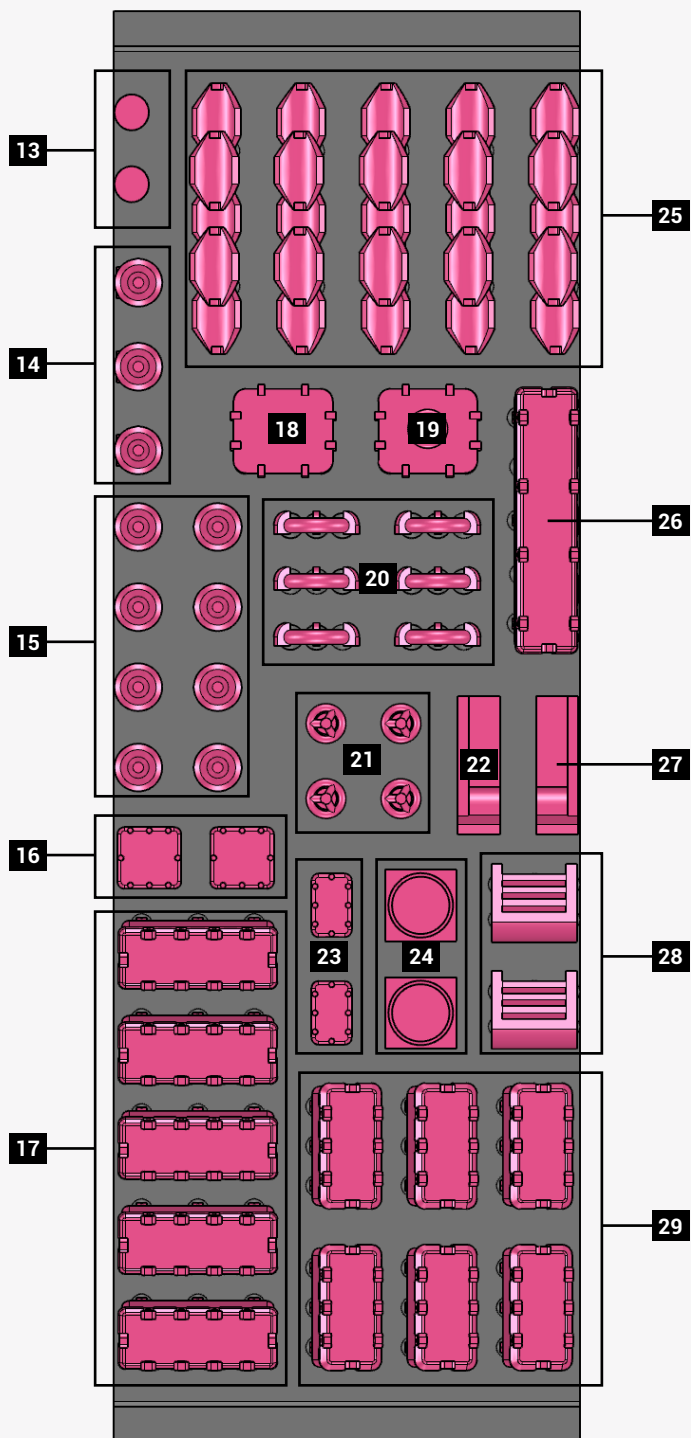

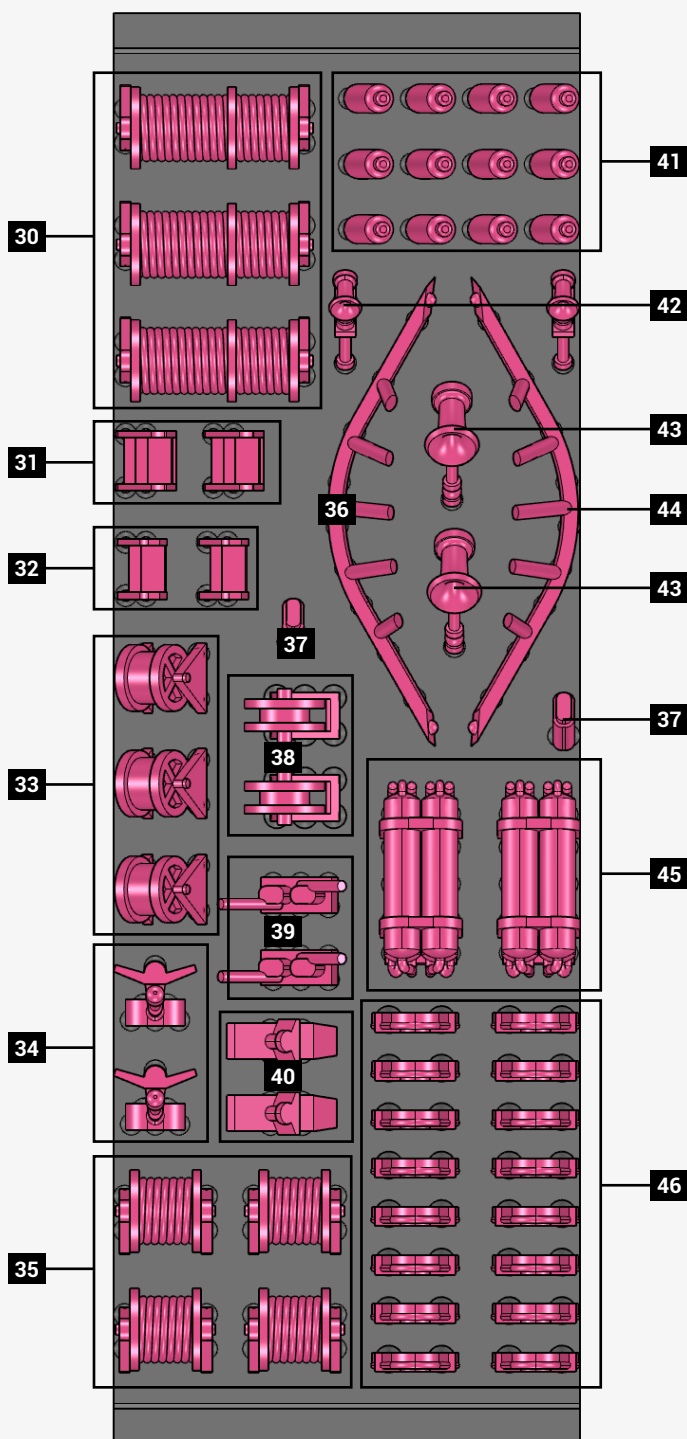

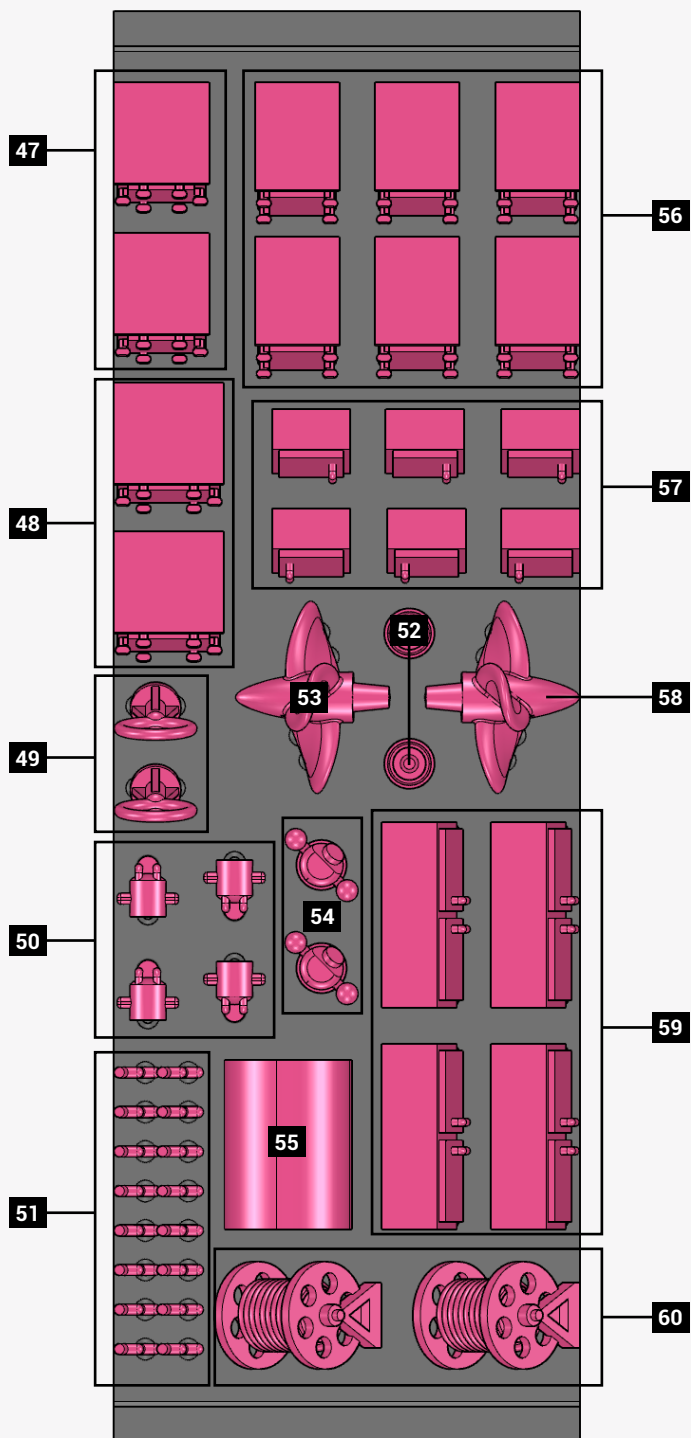

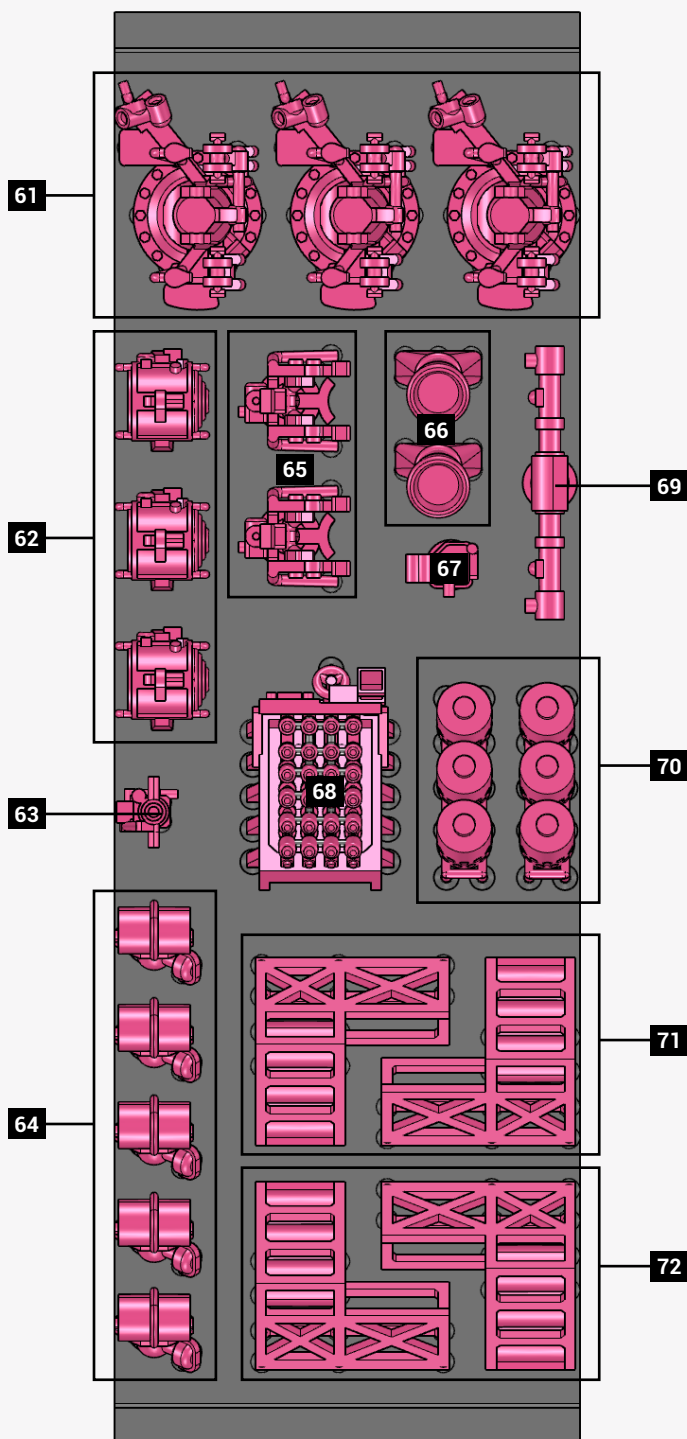

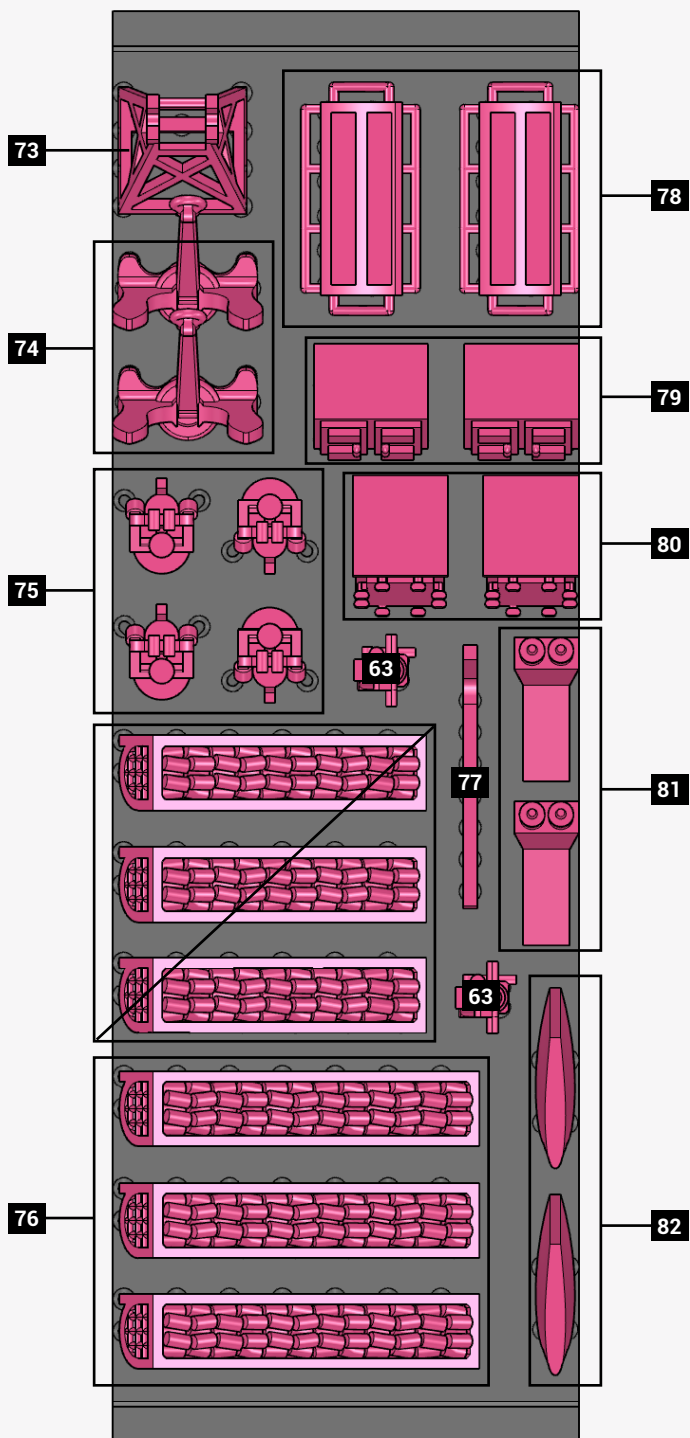

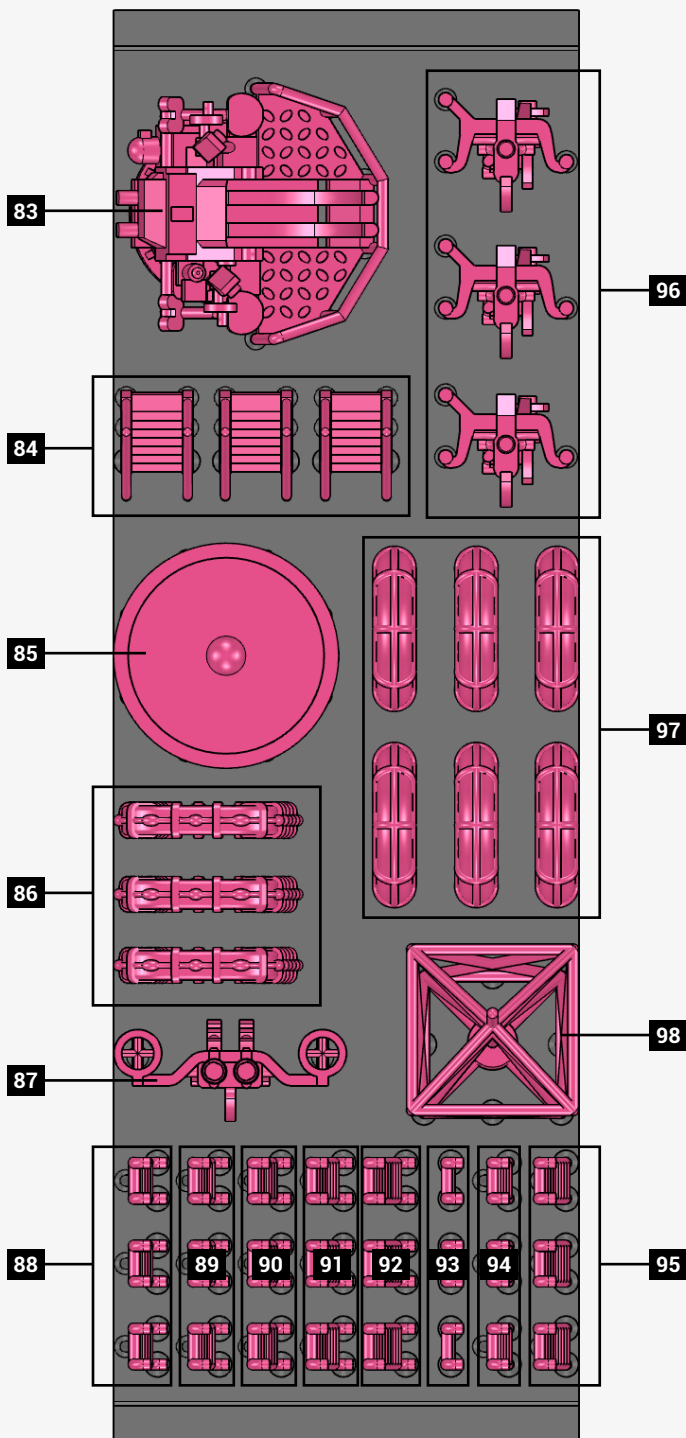

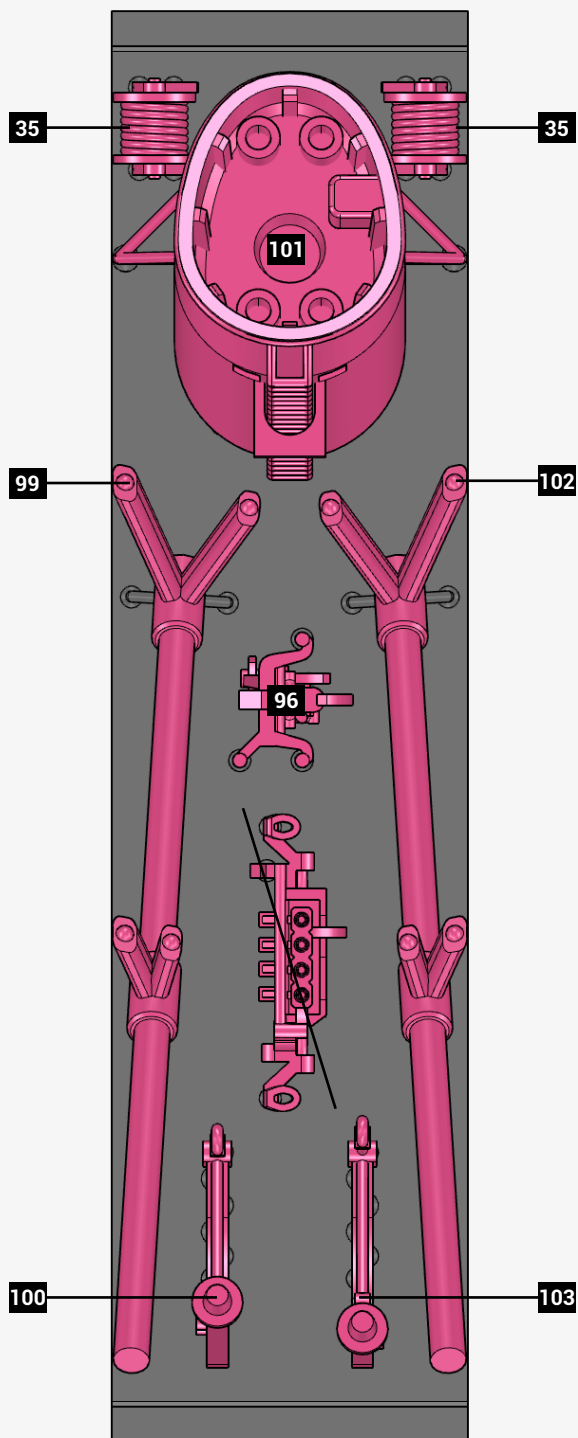

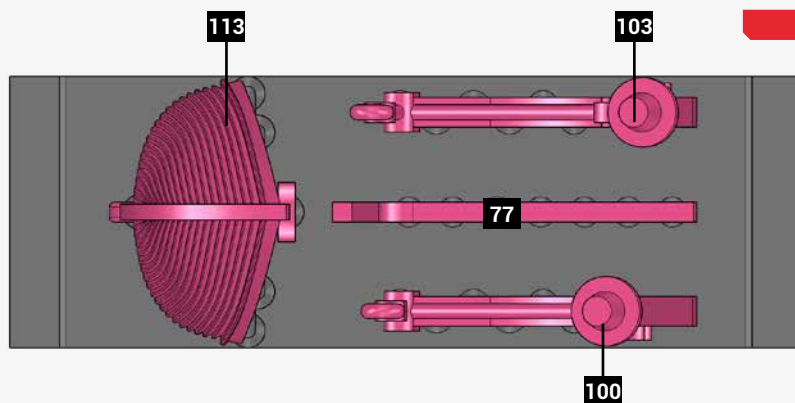
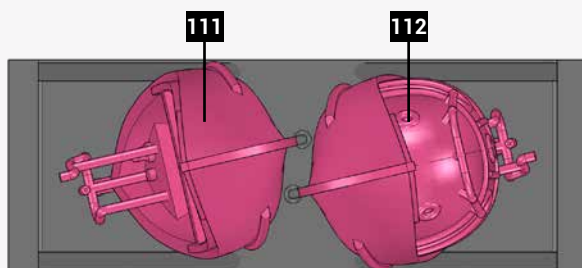
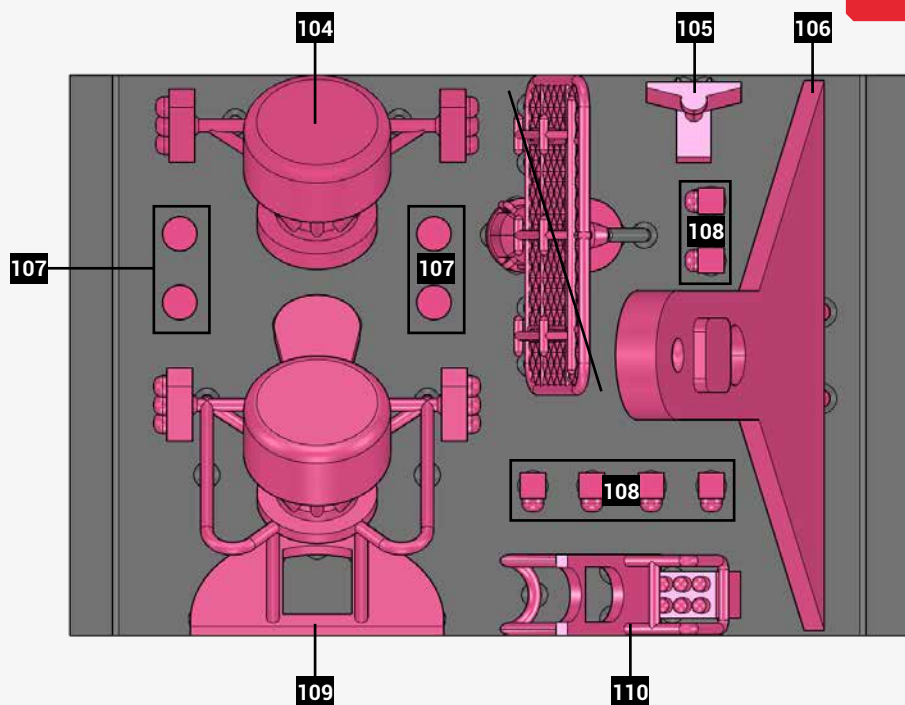

BAR L

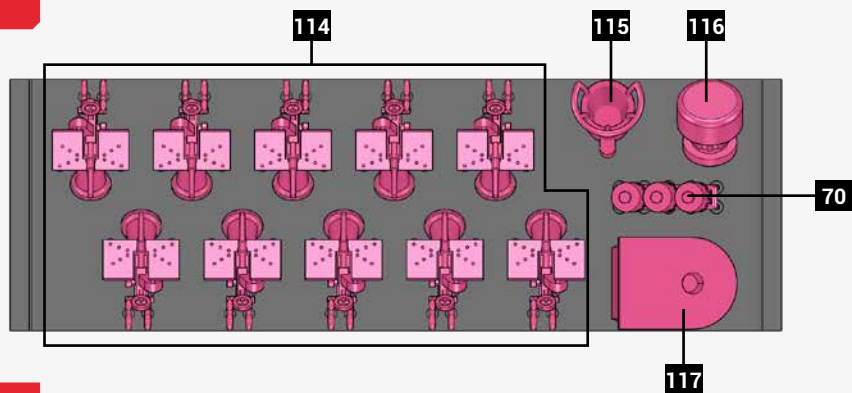

BAR M

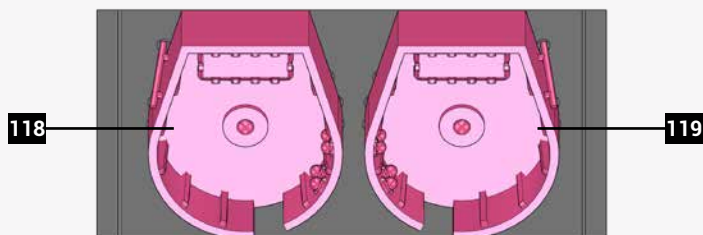

BAR N

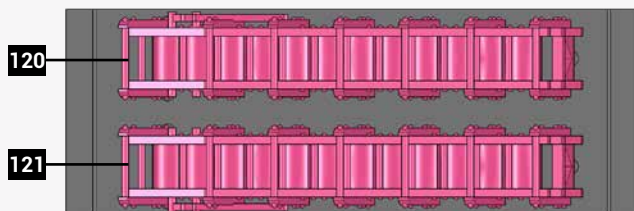

BAR O

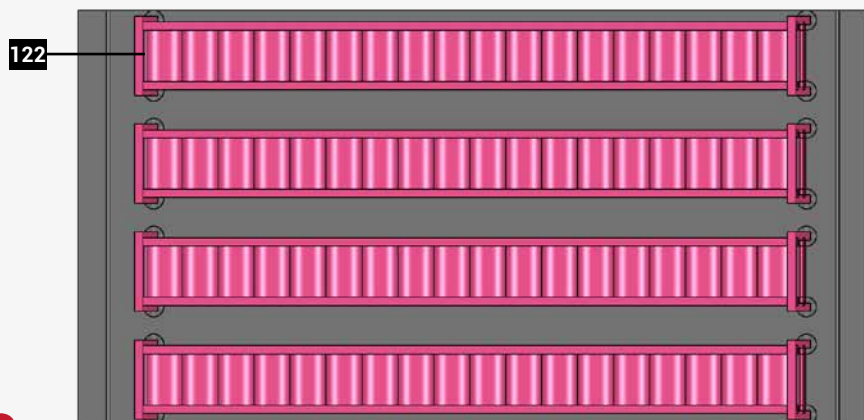

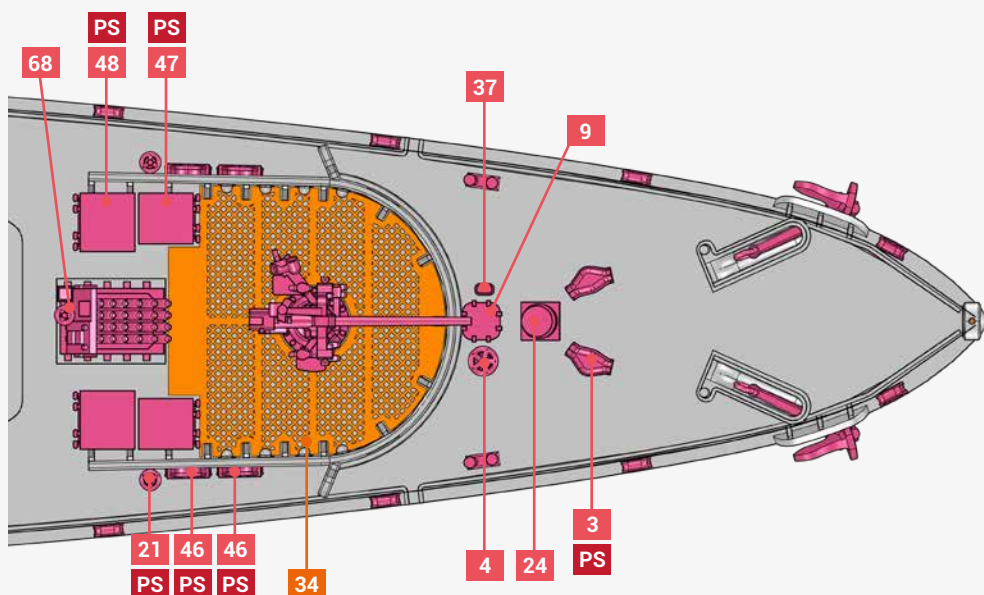
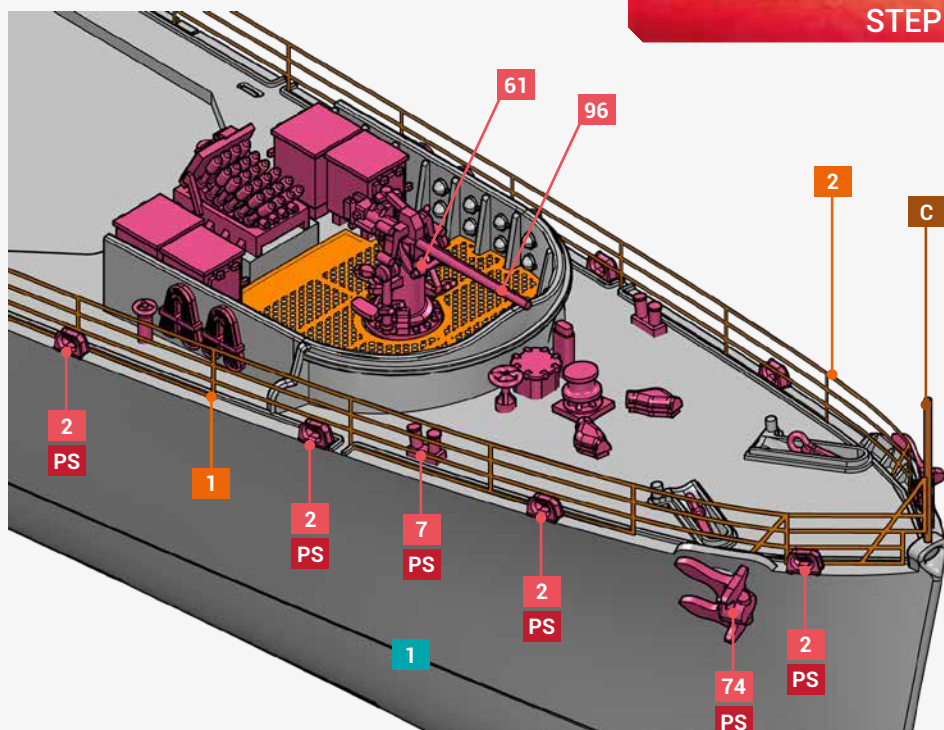

STEP 2

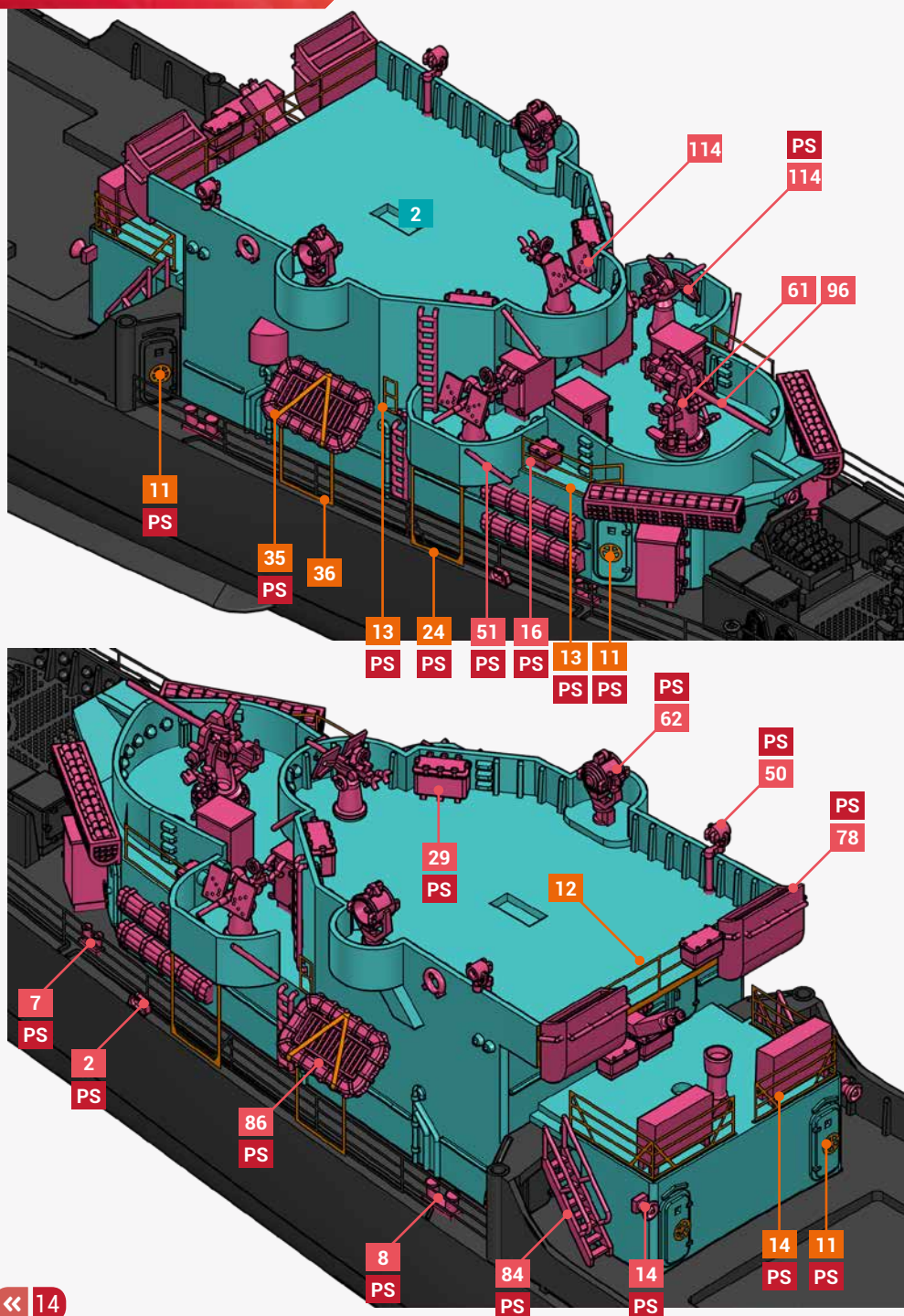

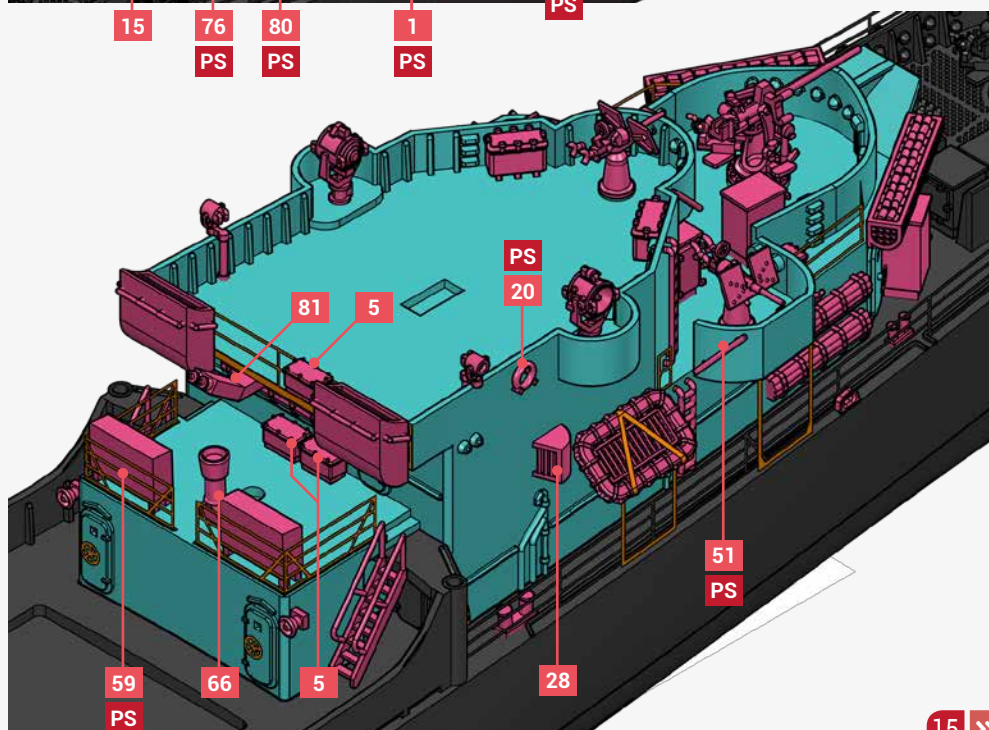
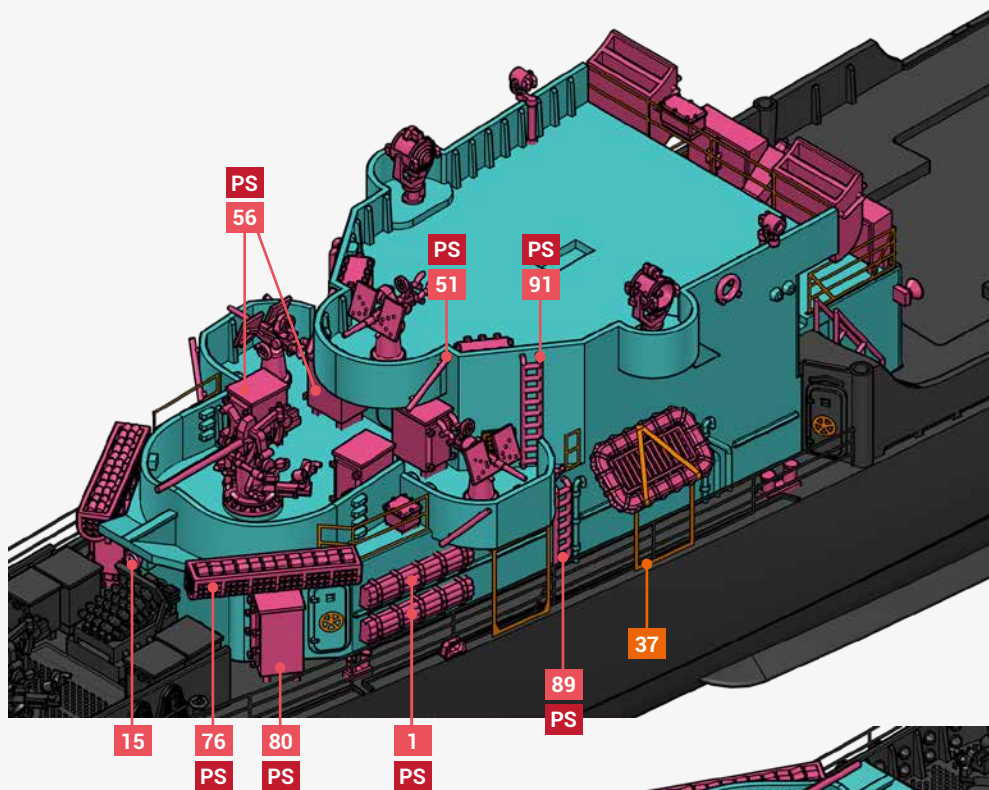

STEP 3

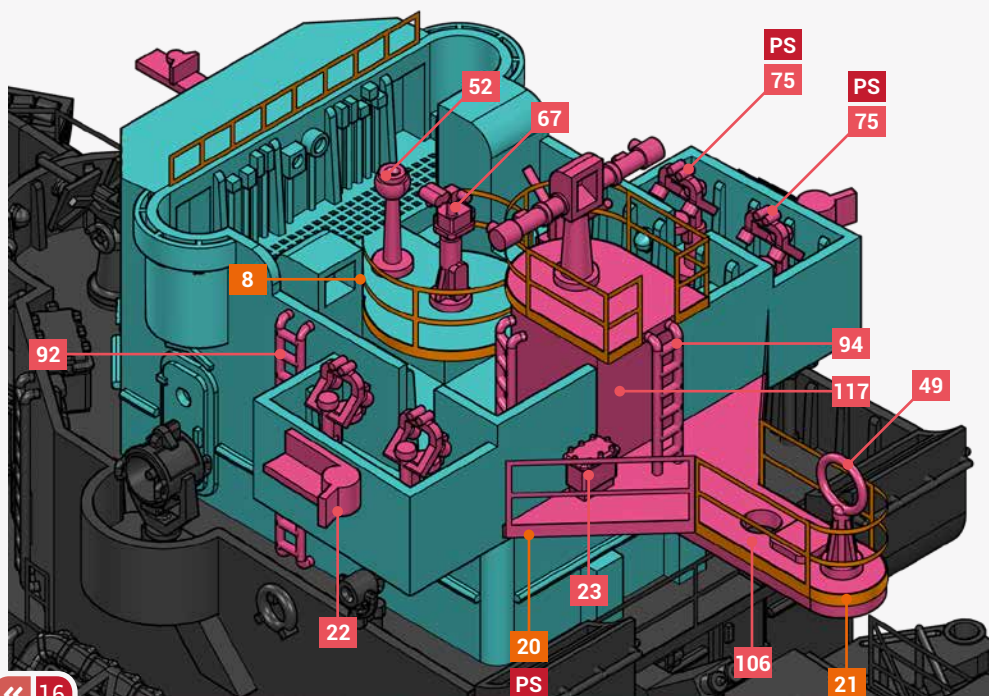
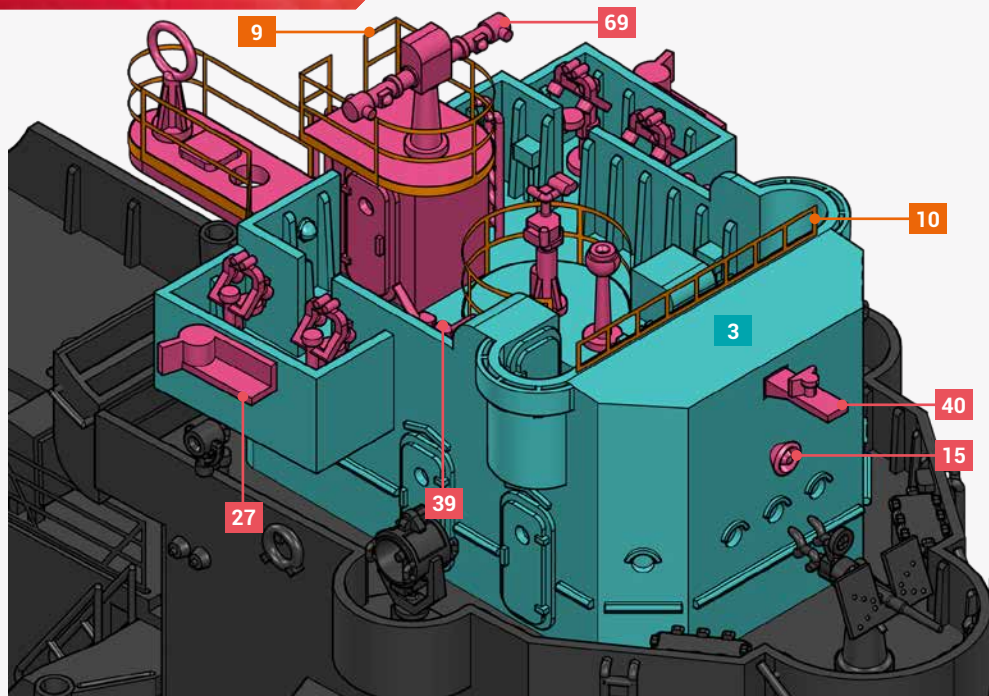

STEP 4

-1 IT IS VERY IMPORTANT TO RESPECT THE MEASUREMENTS GIVEN IN THE INSTRUCTIONS, IF NOT MAST WILL NOT PROPERLY SIT ON THE DECK.

-2 FIRST CEMENT PRINTED PART 106 TO THE BRIDGE AS SHOWING AND LET IT DRY FOR AT LEAST 24 HOURS. PART IS PARALLEL TO THE DECK.

-3 FOLD THE LOOPS OF UPPER LADDER PE PART 31 AND INSERT THE MAST, BRASS PART A, THROUGH THE LOOPS. FOLD PE PART 26 INTO A U (SAME DIAMETER AS THE MAST) AND CEMENT IN PLACE. THEN ASSEMBLE ALL YARDARM PARTS AND CEMENT IN PLACE. ATTACH PRINTED PART 110 IN PLACE BEFORE THE BOTTOM LADDER PE 30, AND THE. ADD ALL OF THE PRINTED PARTS TO THE MAST. AT THIS STAGE OF THE ASSEMBLY MAST COULD BE PUT IN ITS DEFINITIVE PLACE ON THE HULL.

-4 LASTLY BUILD ALL THE ACCESSORIES FOUND ON THE MAST TOP, PLATFORMS, RADAR ANTENNA, ETC... AND YOU'RE DONE !

PE PART 27 IS UNDER THE 3D PART 115

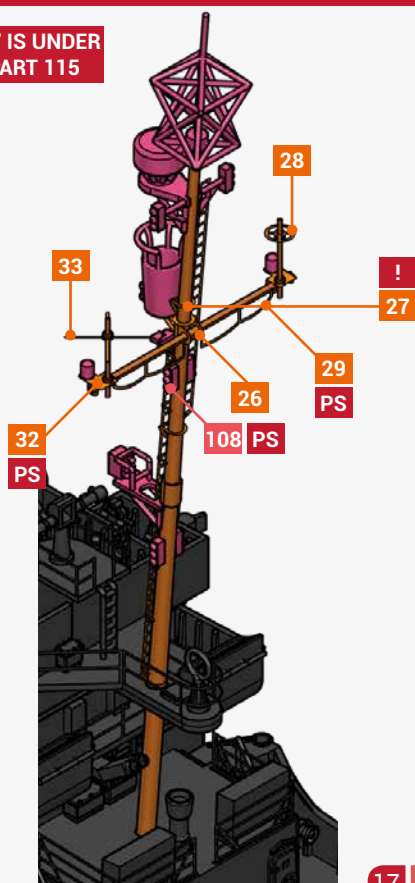
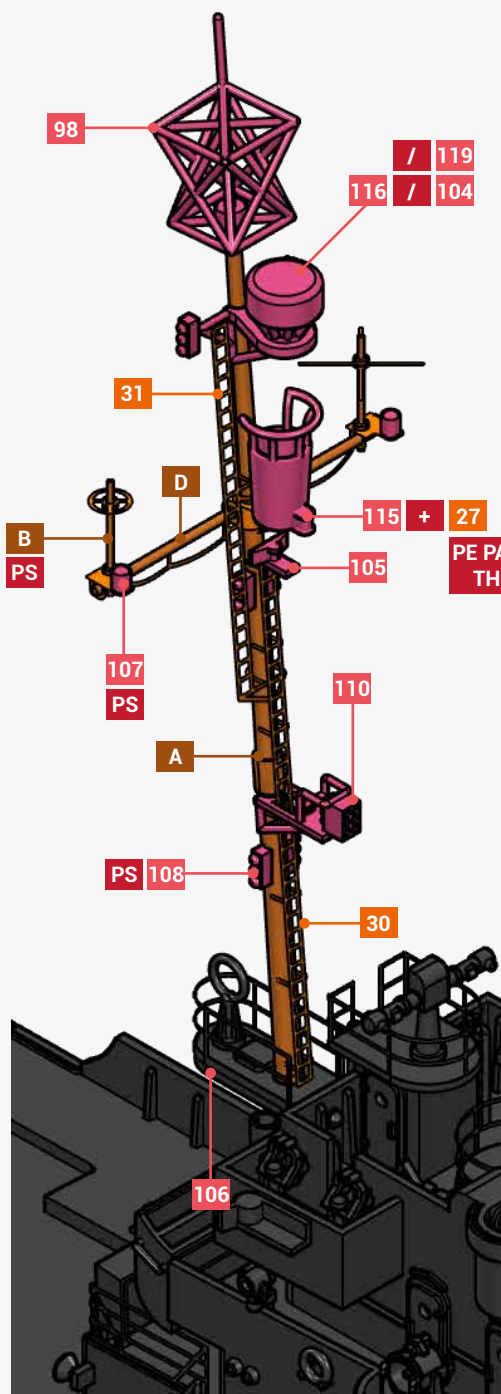

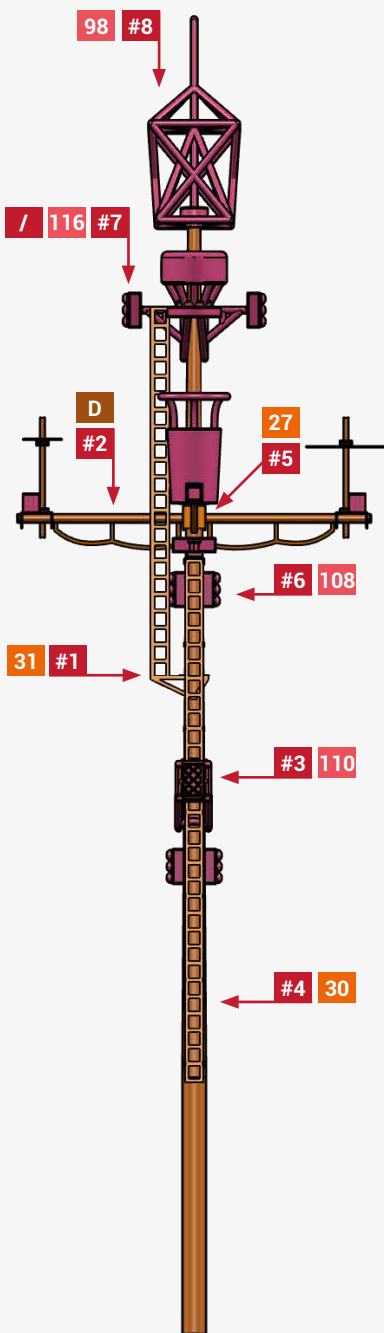
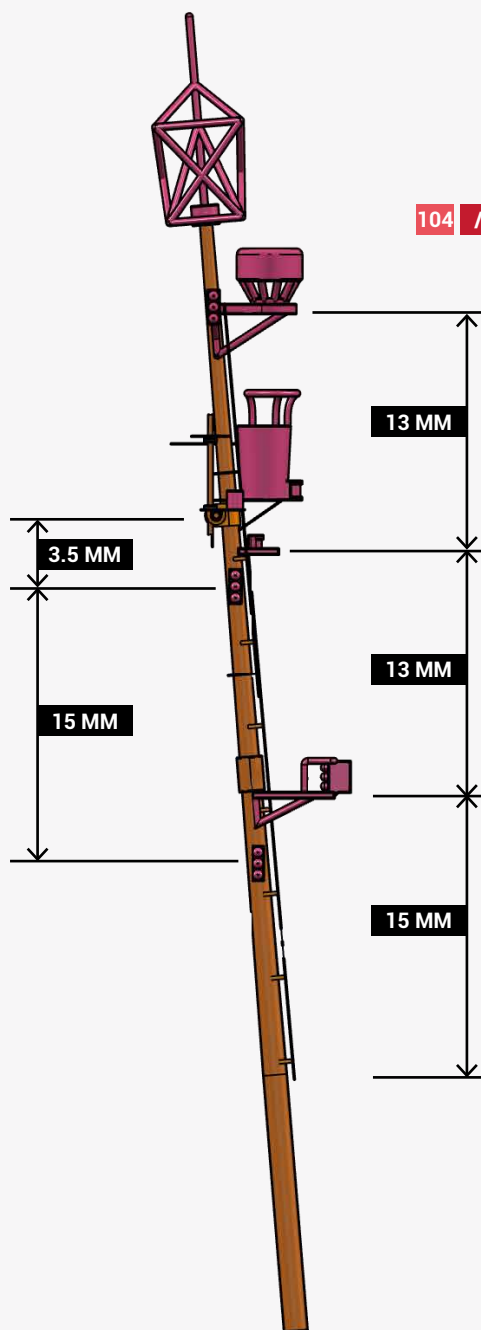

STEP 5

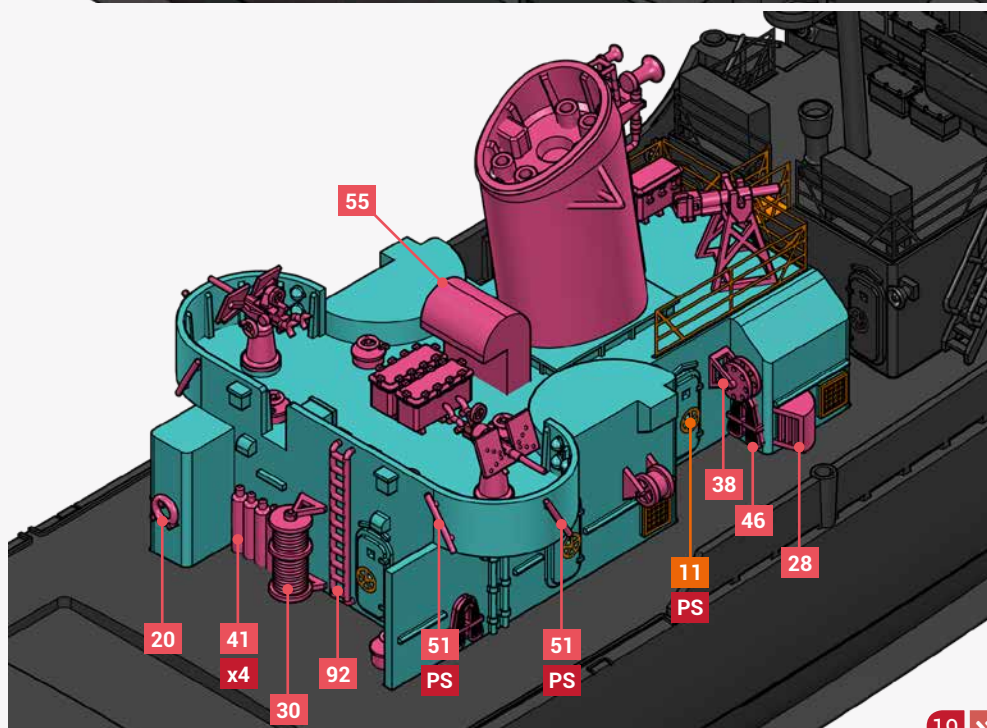
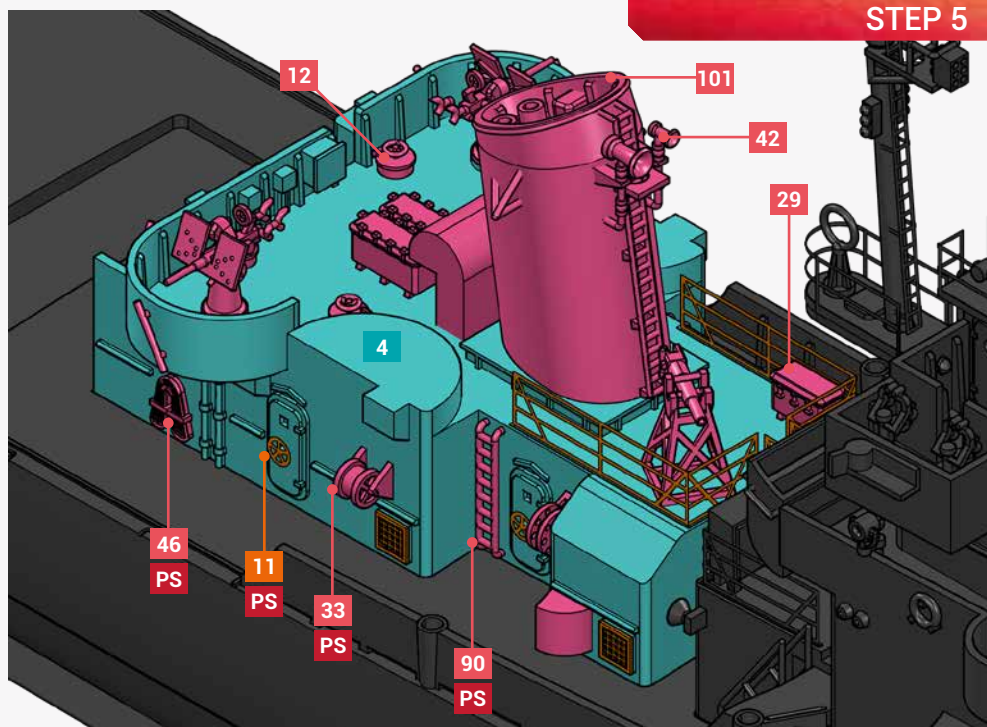

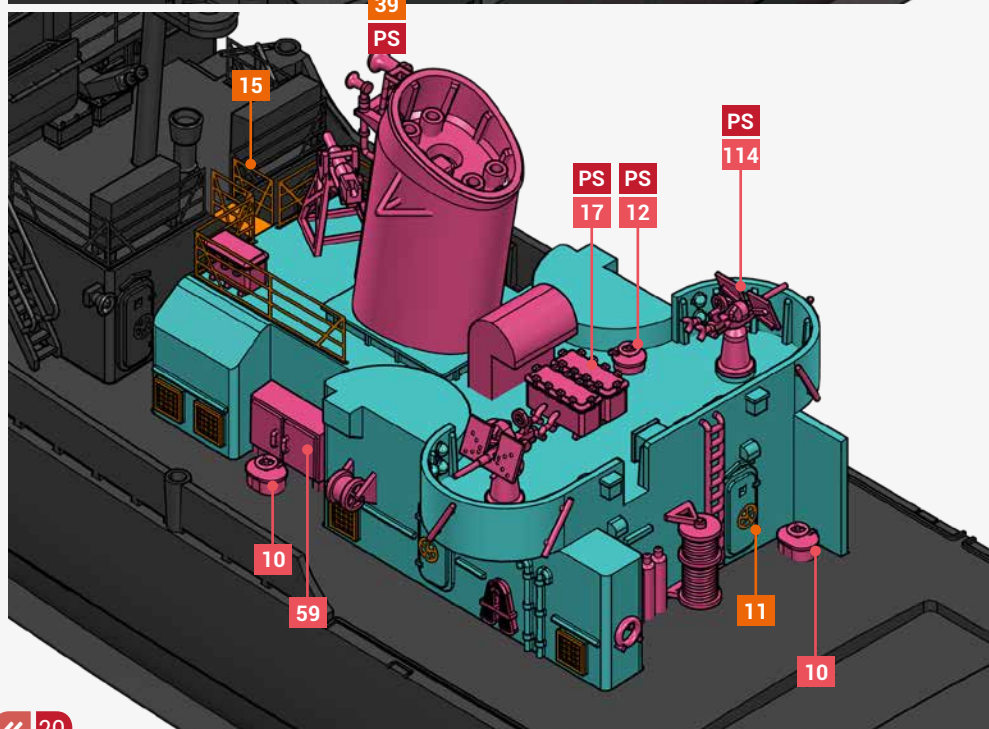
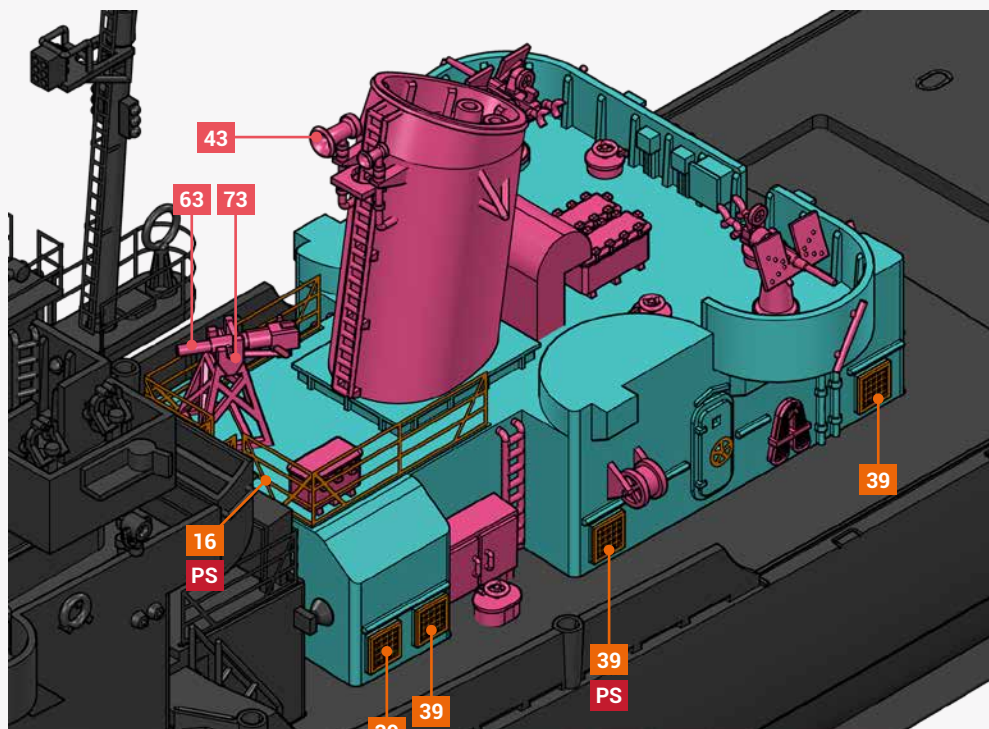

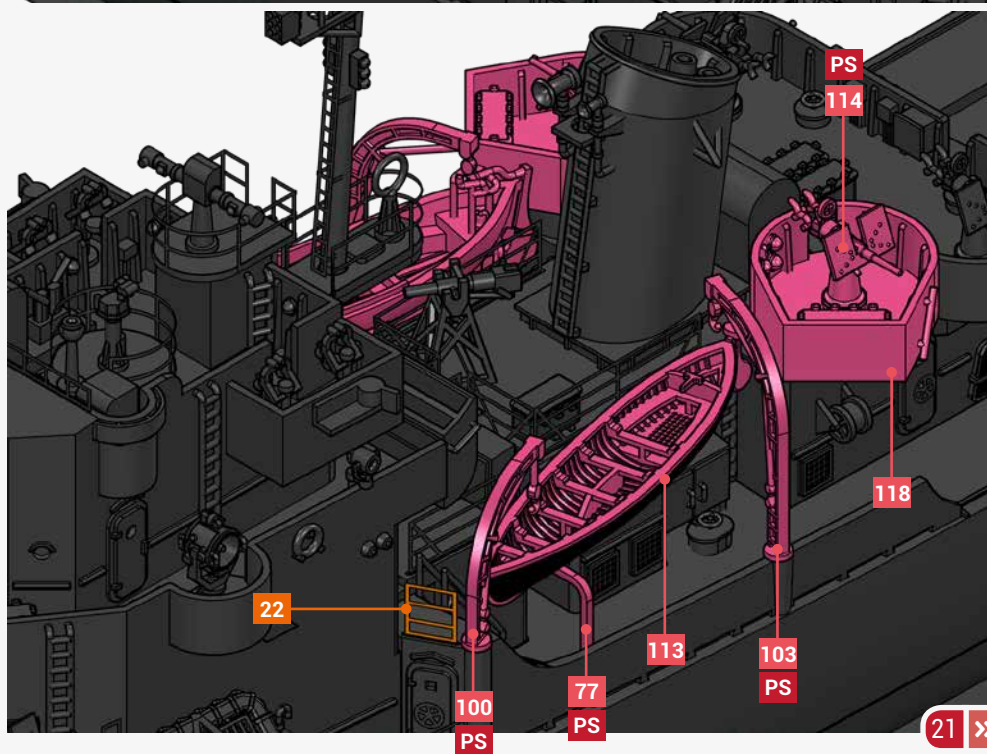
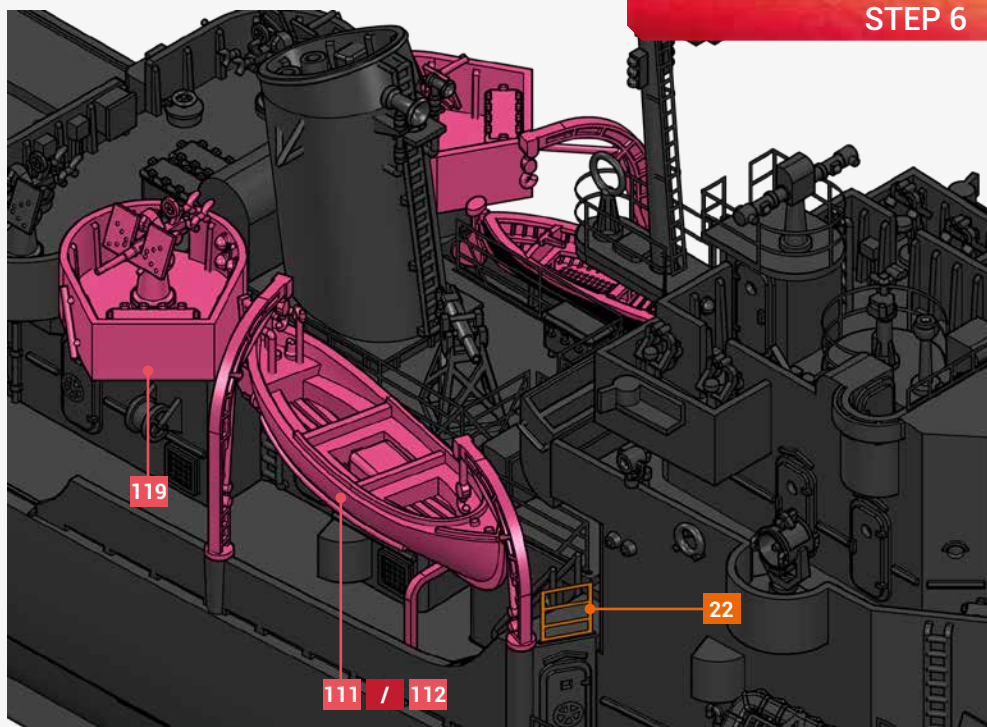

STEP 7

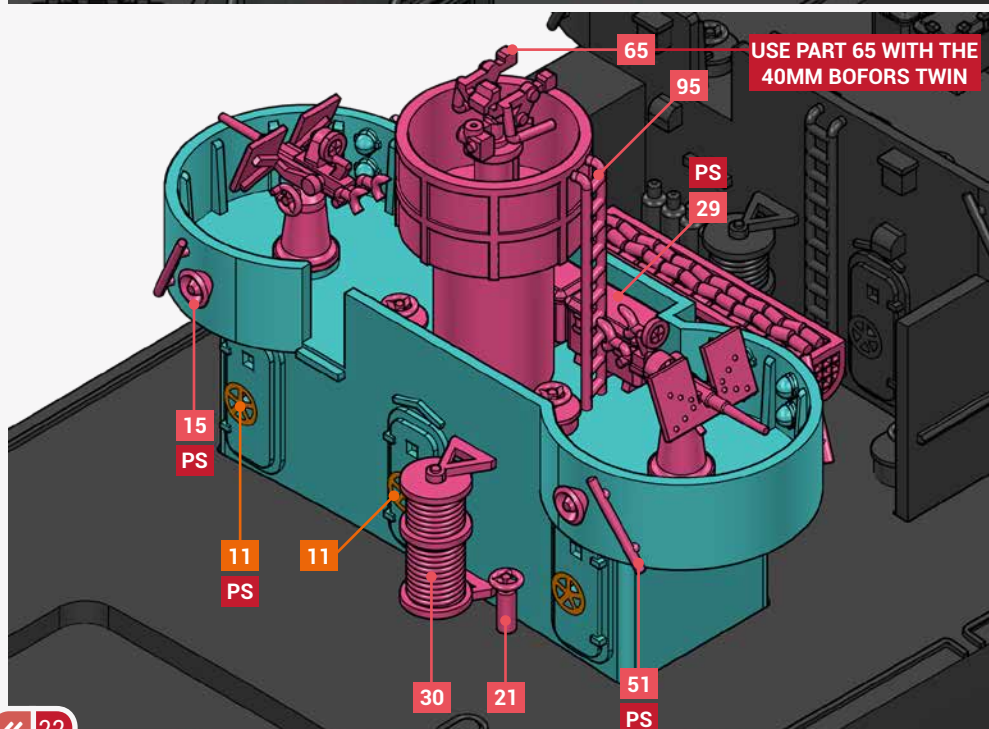
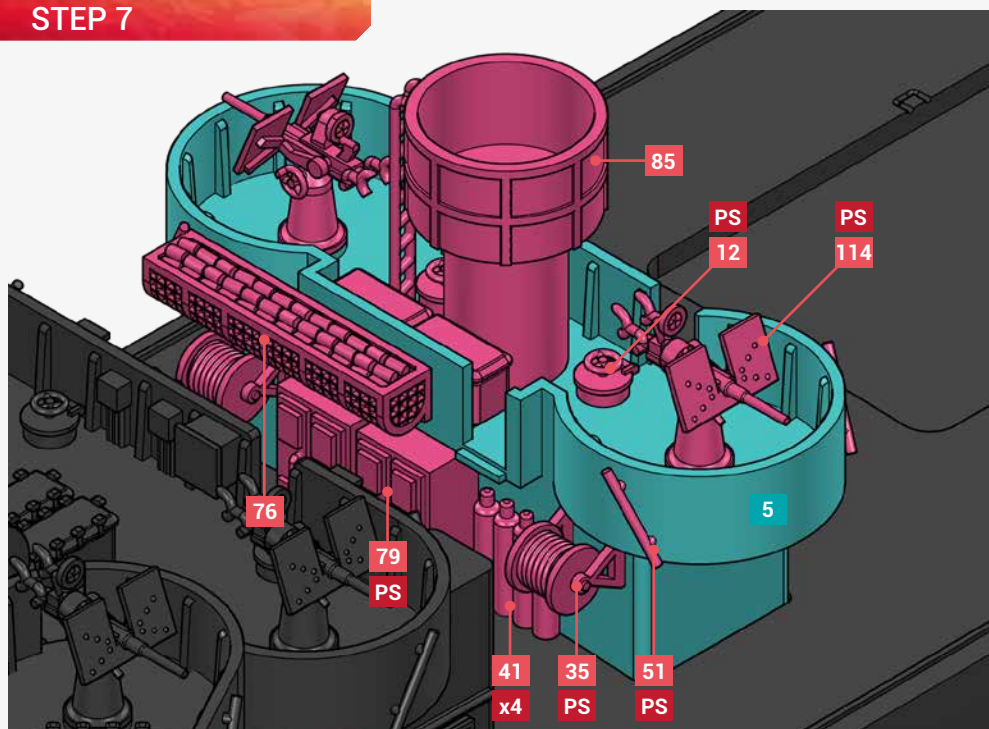

STEP 8

CONFIGURATION A WITH 20MM GUN

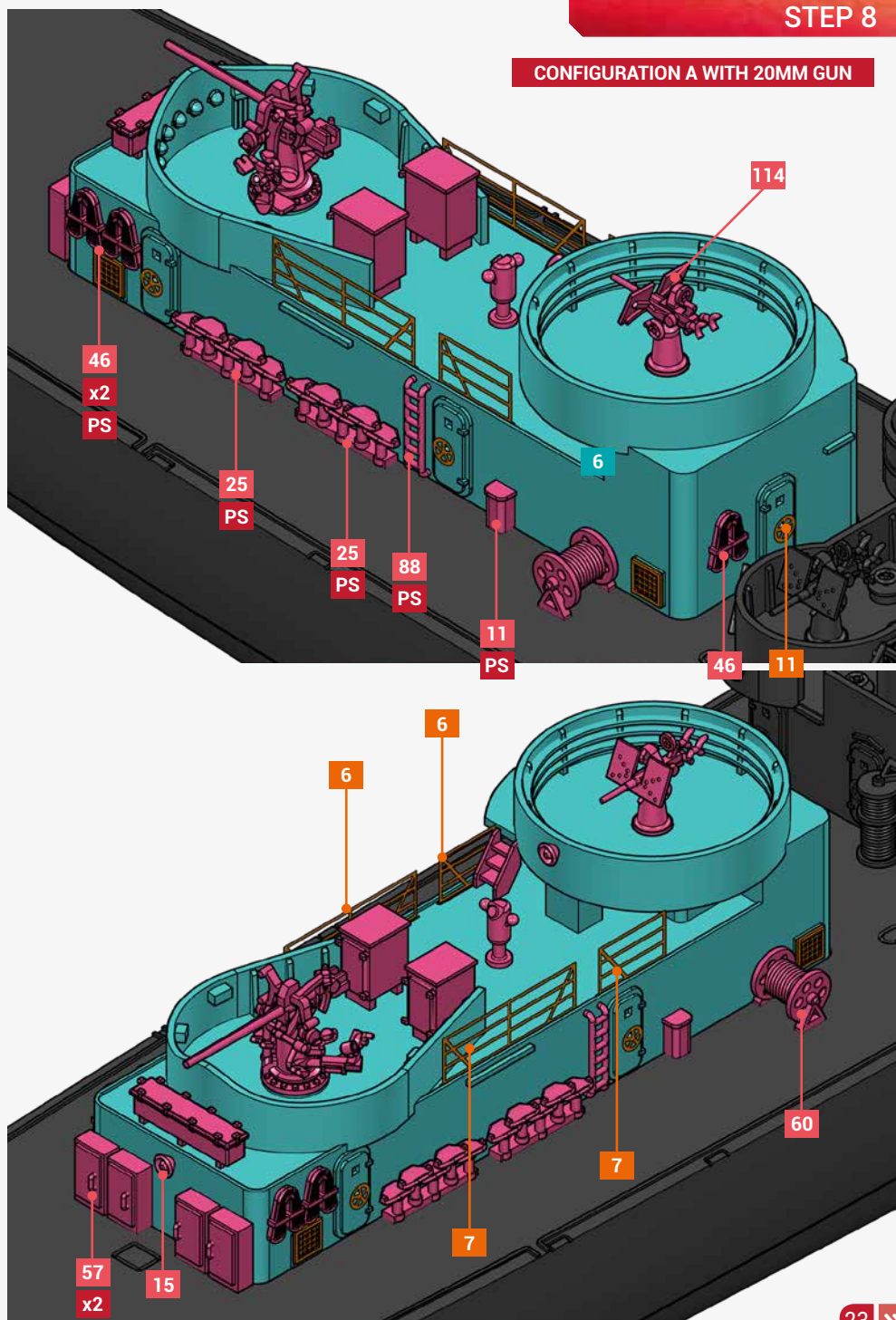

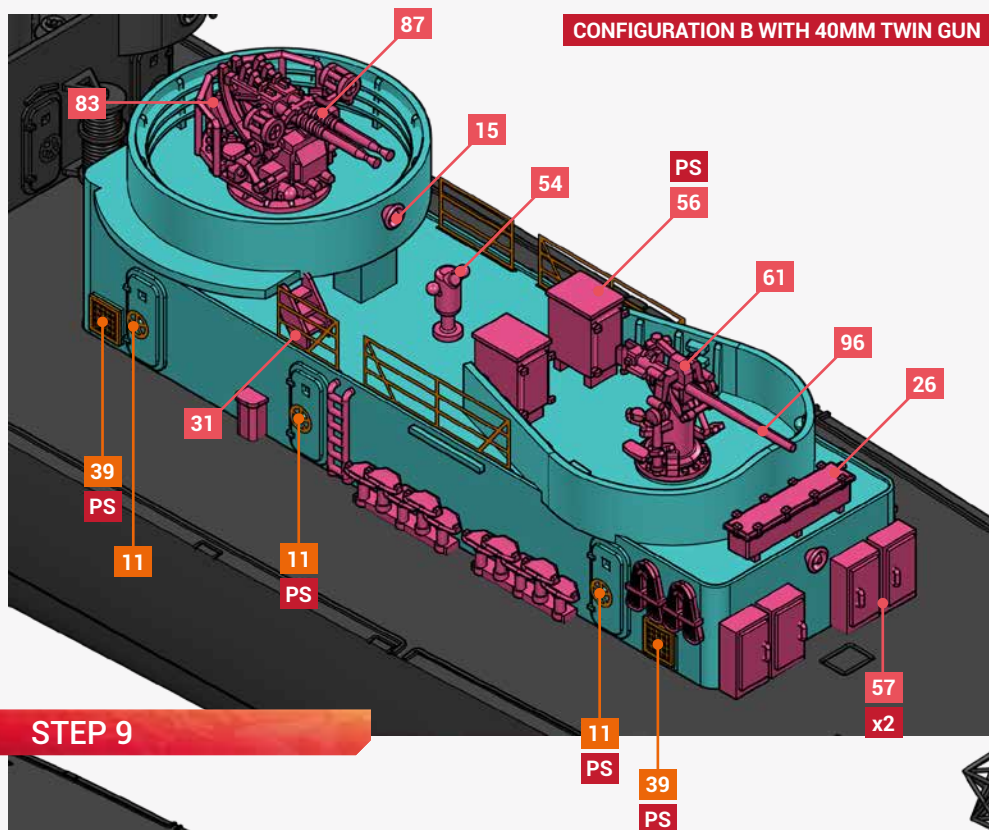

STEP 9

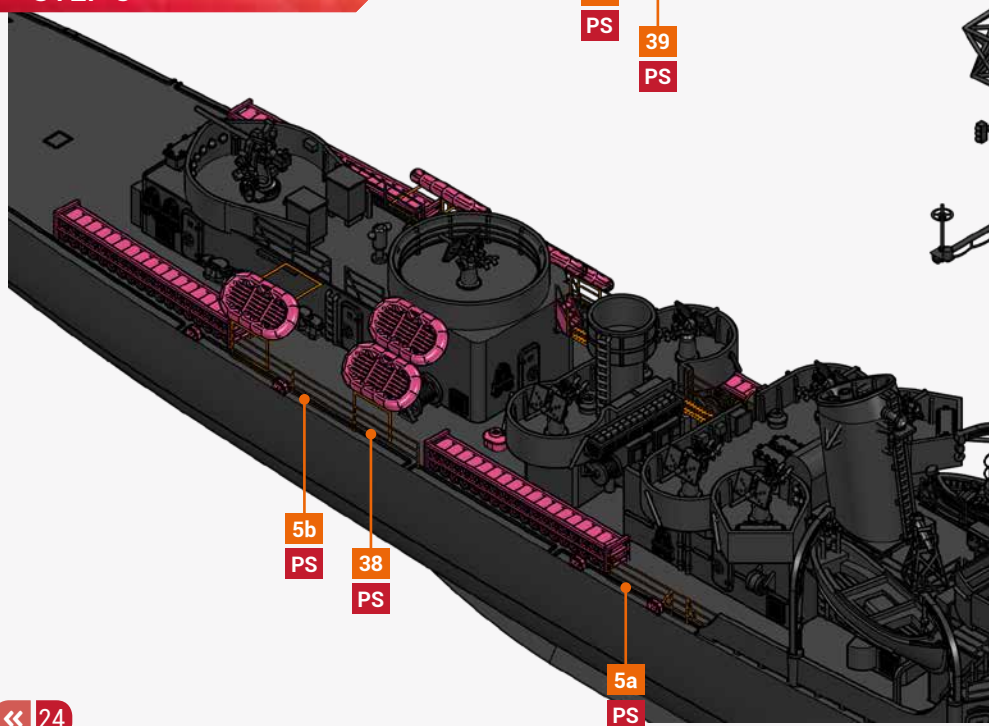

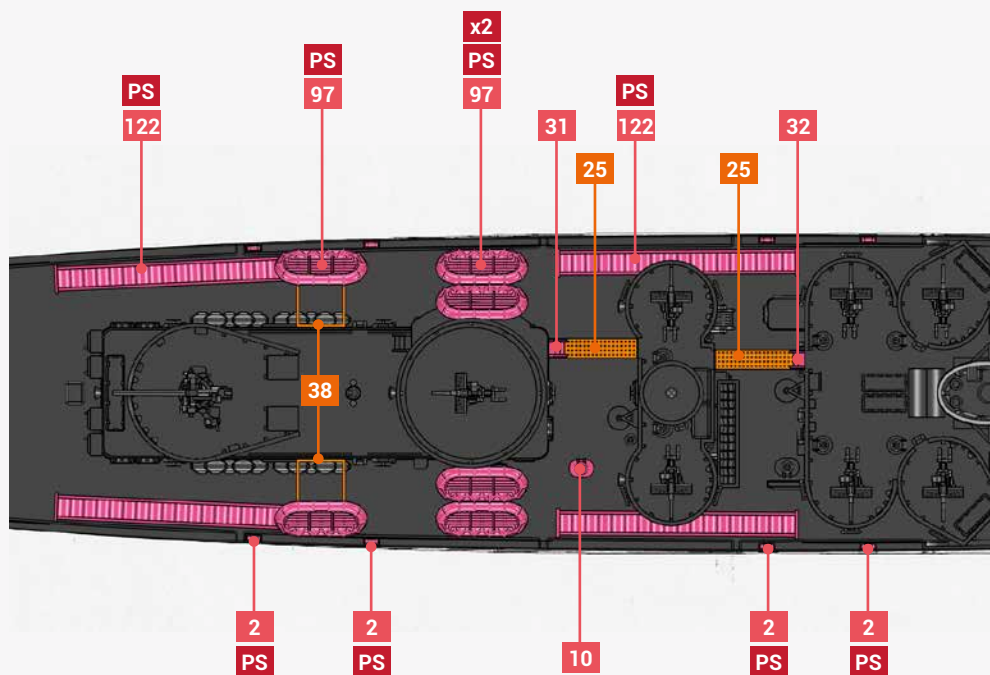

STEP 10

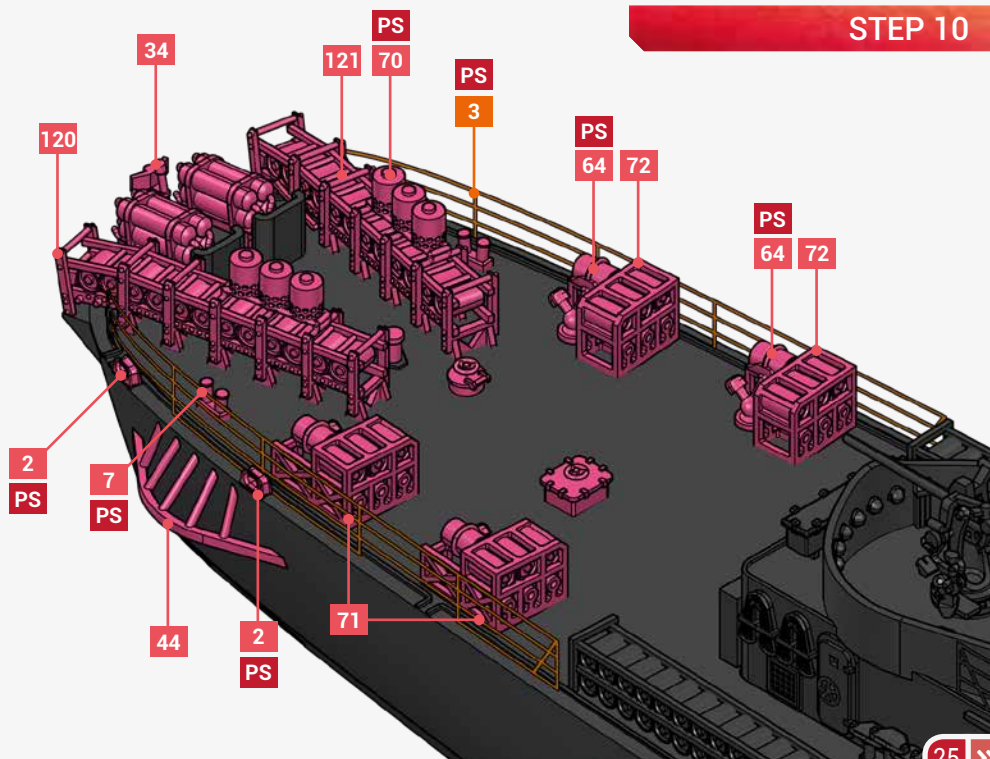

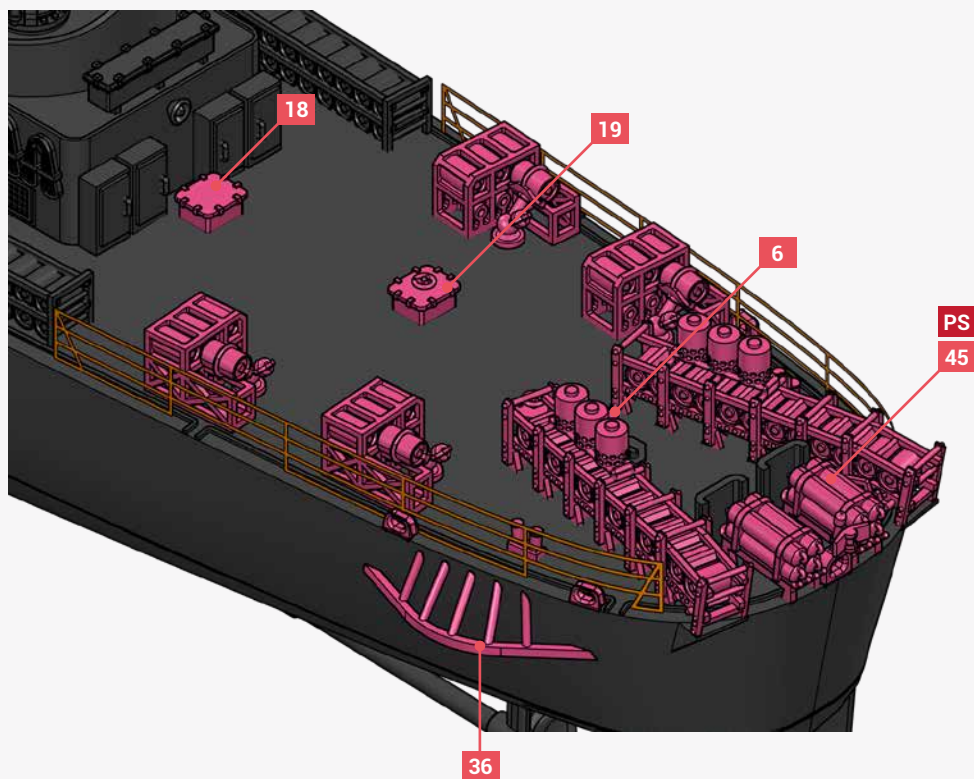

STEP 11

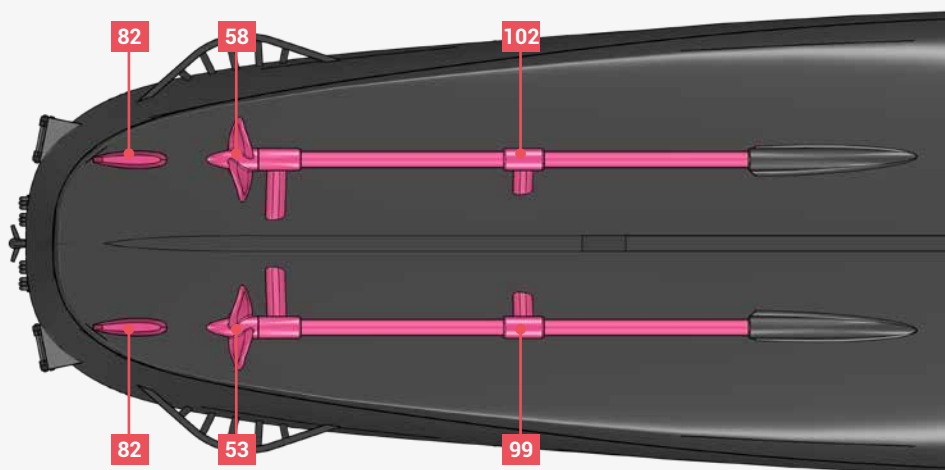

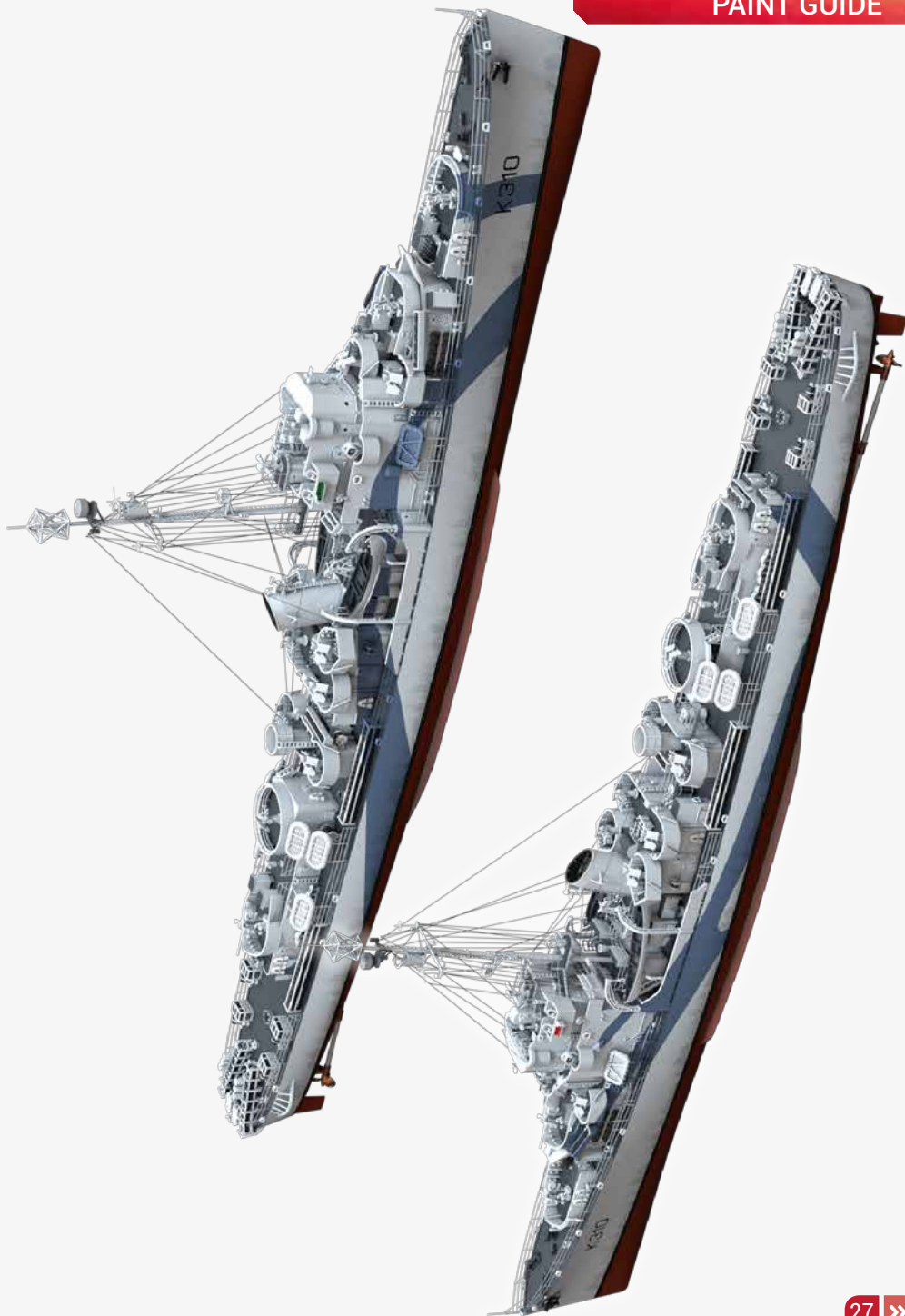

TEXT FOR CAPTAIN'S COLOR SCHEME

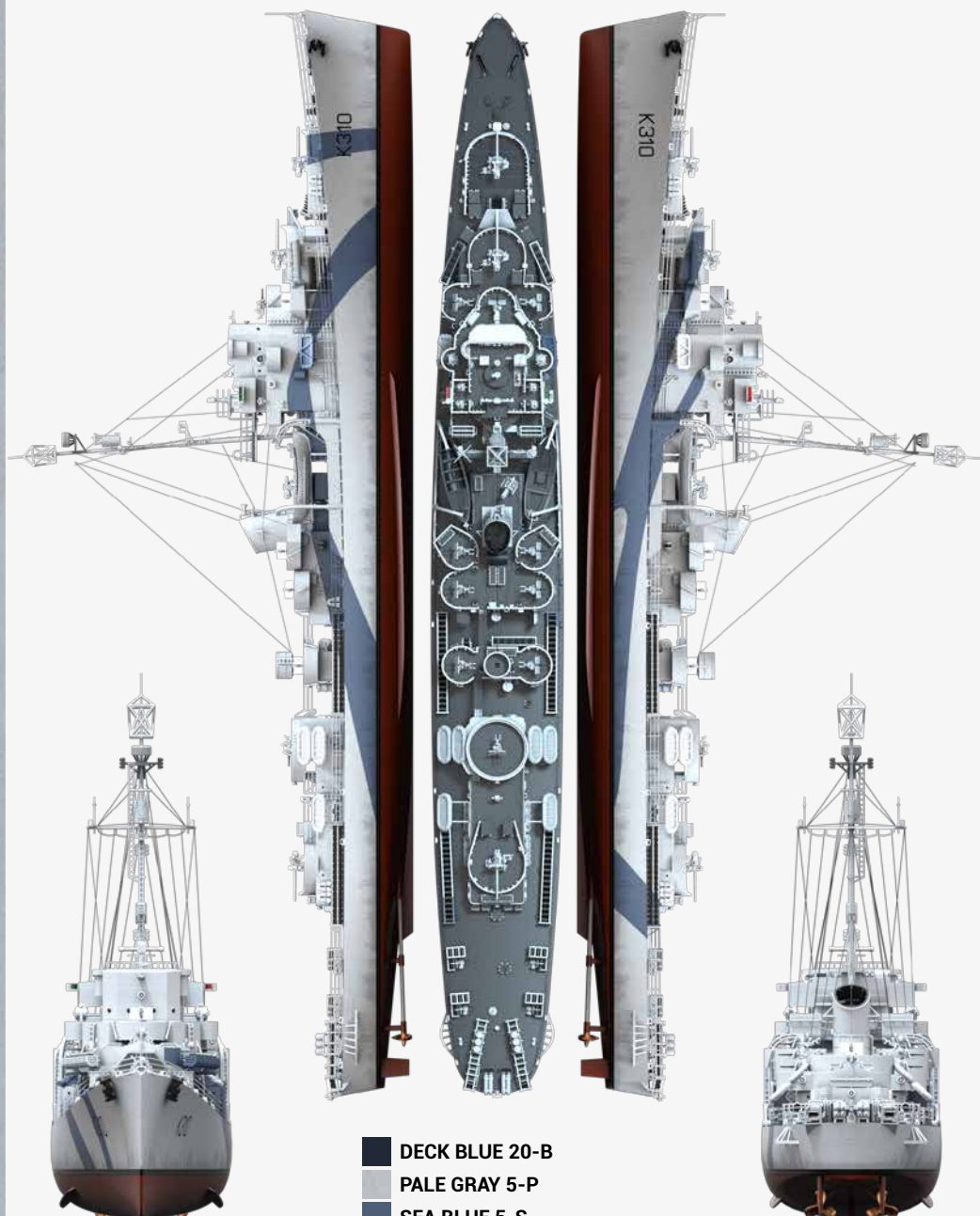

- DECK BLUE 20-B
- PALE GRAY 5-P
- SEA BLUE 5-S
- BLACK
- ANTI FOOLING RED